

WARNING:

- This product must be installed in accordance with the applicable installation code by a person familiar with the construction and operation of the product and the hazards involved.
- Make sure all electrical power is turned off while installing the fixture.
- This luminaire must be adequately grounded for protection against shock hazards and to assure proper operation.
- Disconnect power before servicing.
- LEDs are ESD (Electro Static Discharge) sensitive devices that can be easily damaged if the proper ESD mitigating steps are not taken.
- LEDs are very sensitive to mechanical damage. Caution must be taken to avoid damage to the LEDs.
- ESD or mechanical damage voids all warranties.
- Suitable for dry and damp locations.

TABLE OF CONTENTS

STAND-ALONE ASSEMBLY.....	1	WIRING DIAGRAM.....	4
ROW ASSEMBLY.....	2	ASY OPTION INSTALLATION.....	4

STAND-ALONE ASSEMBLY (See page 2 for Row Assembly)

STEP 1: For T-bar ceiling, install mounting brackets at desired locations. T-bar mounting bracket halves are supplied as a one-piece metal stamping. Bend inward at middle until bracket breaks into two pieces. Insert 1/4 - 20 threaded stud into "A" half of bracket.

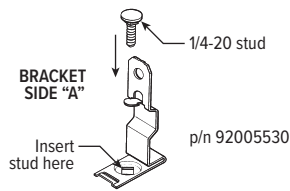

STEP 2: T-bar mounting bracket halves interlock and snap together around T-bar. Brackets must be placed exactly on each mounting point for correct installation and hanging of cables.

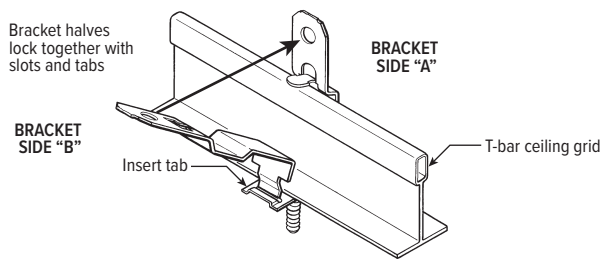

STEP 3: A stand-alone fixture will require two suspension cables with grippers and mounting hangers. For safety, always support the weight of the fixture. **Do not leave a fixture hanging by only one end while working.**

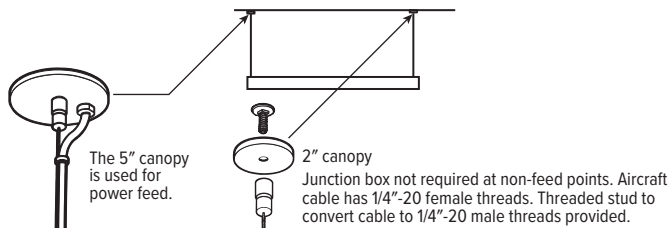

STEP 4: Hanger at ends of fixture are pre-attached loosely to each end plate.

A. Install hanger. Rock hanger up and tighten with phillips head screw driver. Insert cable into hanger. Repeat on opposite end.

END HANGER

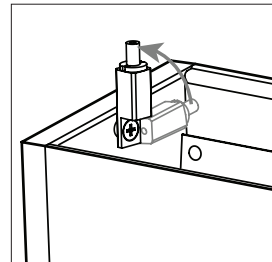

B. Level fixture and cut excess cable. Leave a minimum of 1" cable coming out of the gripper.

STEP 5: Make electrical connections in accordance with NEC and local codes. See "WIRING DIAGRAM" on page 4.

STEP 6: The lens will need to be cut to fit around the hangers. Measure and cut lens with a fine tooth cut off saw, feeding slowly.

STEP 7: Install the lens.

- A.** Insert one side of the lens into one side of the fixture housing.
- B.** Push the corner of the opposite side of the lens into place.
- C.** Continue pushing along the housing until the entire lens is installed.

- To remove the lens, pry out starting with the 4" wide end.
- Repeat steps 7A – 7C for top lens installation.

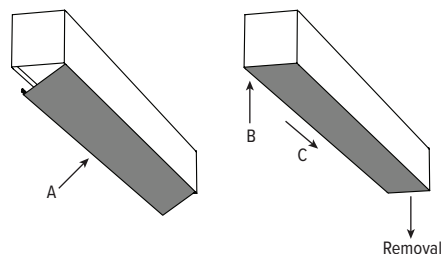

MX4UD

INSTALLATION INSTRUCTIONS

ROW ASSEMBLY

STEP 1: For T-bar ceiling, install mounting brackets at desired locations (see stand-alone assembly step 1 & 2).

STEP 2: Install mounting cables at desired locations. Only the first fixture in each row will require two suspension cables. Each adjoining fixture will require only one cable before attaching to the previous fixture. For safety, always support the weight of the fixture. **Do not leave a fixture hanging by only one end while working.**

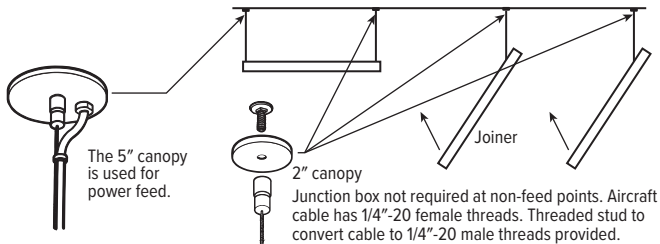

STEP 3: Lay out extrusions so that the row aligners are on opposite sides of connecting pieces.

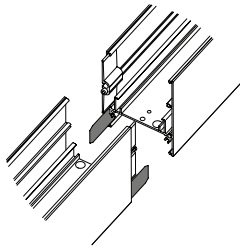

STEP 4: Install light block plates into leading end of joiner extrusion.

A. Insert plates approximately 1/2" and bend outward to create binding at Step 4B.

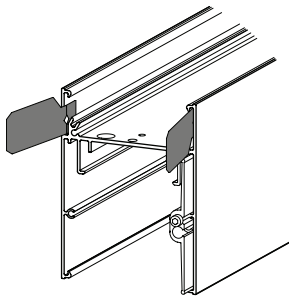

B. Continue to insert the side shims until the wider part of the plate is halfway into the extrusion.

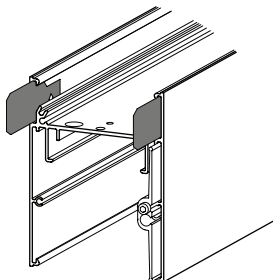

STEP 5: For safety, always support the weight of the fixture. Do not leave a fixture hanging by only one end while working. Hanger at ends of fixture are pre-attached loosely to each end plate.

A. Install hanger.

END HANGER

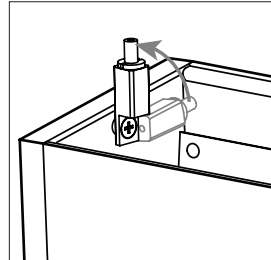

Rock hanger up and tighten with phillips head screw driver. Insert cable into hanger.

JOINER HANGER

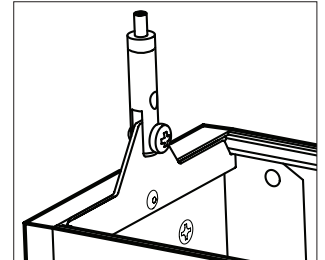

Insert hanger, squeeze together, and install screw.

B. Level fixture and cut excess cable. Leave a minimum of 1" cable coming out of the gripper.

STEP 6: While supporting the weight of the next extrusion, clip the next hanger piece into the next extrusion (see Stand-Alone, Step 4).

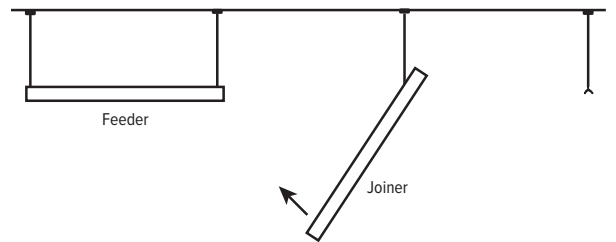

STEP 7: Connect row aligners using 10-24 x 1-1/2" socket head cap screw provided and 5/32" ball end hex bit. Secure tightly to achieve flush seams.

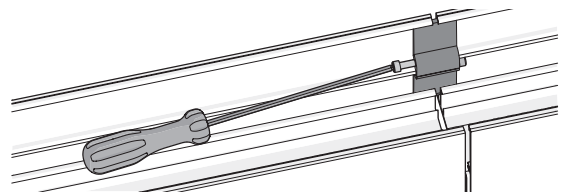

STEP 8: Repeat steps 6 and 7 until the row is complete.

STEP 9: Remove the row aligner from the end of the row-end extrusion using 5/32" ball end hex bit.

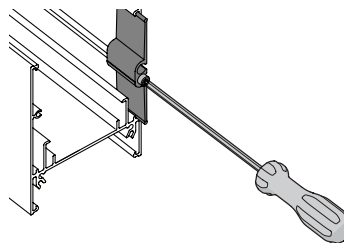

MX4UD

INSTALLATION INSTRUCTIONS

STEP 10: Install end plate onto end of row-end extrusion (or single extrusion) using 10-24 x 1" SST socket head cap screw.

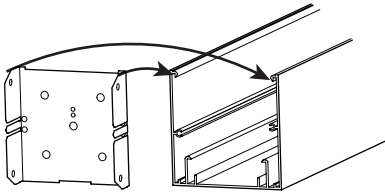

- Install and secure end cap from inside using (4) #8 x 1/4" flathead screws provided.

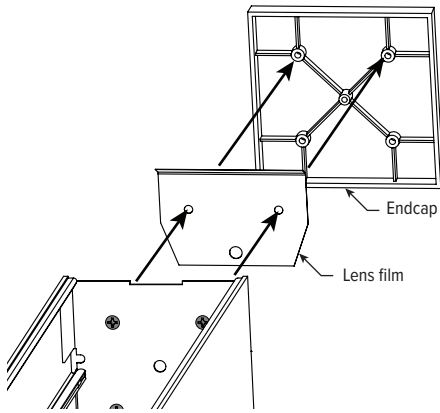

STEP 11: Starting with the feeder unit, thread power cord up through the extrusion and upper LED rail. Make electrical connections in accordance with NEC & local codes. See "WIRING DIAGRAM" on page 4.

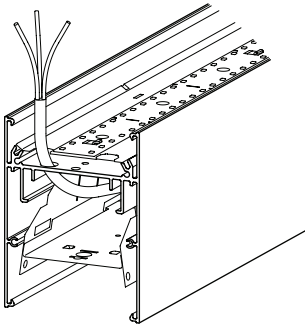

STEP 12: Install LED light cartridges.

- Connect upper LED rail to light cartridge and push connection into the cartridge.
- Snap light cartridge into extrusion leaving room to connect the quick-connect harnesses between cartridges. Visually check that all the catches are engaged.

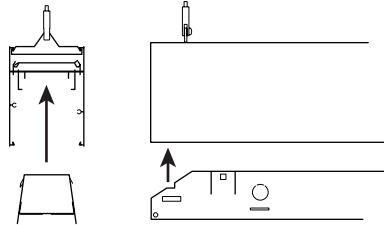

- Connect the quick-connect harness(es). See "WIRING DIAGRAM" on page 4.

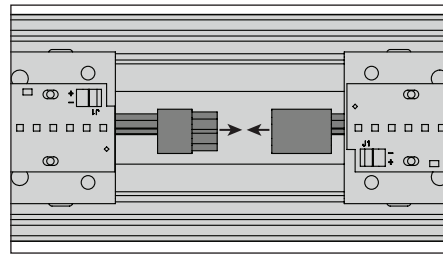

- Slide cartridges tightly together toward the end plate covering the wiring harness(es).

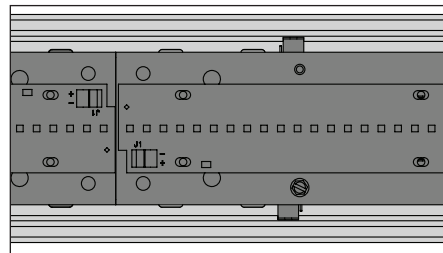
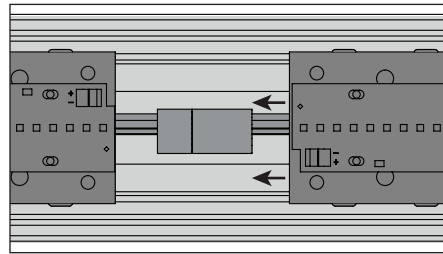

MX4UD

INSTALLATION INSTRUCTIONS

STEP 13: Install the lens.

- Insert one side of the lens into one side of the fixture housing.
- Push the corner of the opposite side of the lens into place.
- Continue pushing along the housing until the entire lens is installed.
 - Cut final Row-Mount lens to length as required.
 - To remove the lens, pry out starting with the 4" wide end.

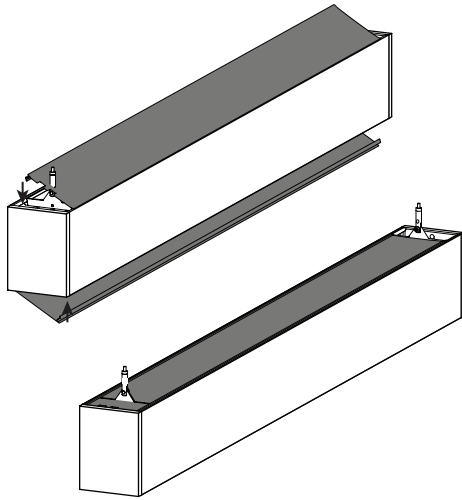

WIRING DIAGRAM

Make electrical connections in accordance with NEC and local codes.

Driver/power supply disconnects accept #12 – #16 AWG stranded or solid wire. Attach power supply and ground wires using UL listed wire connectors. Please consult factory for other driver configurations or emergency driver wiring diagrams.

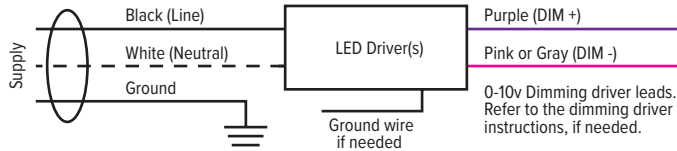

ASY OPTION INSTALLATION

CHANGE DIRECTION OF THROW - DOWNLIGHT

- Remove (3) screws from reflector.
- Snap bracket out of channel, then rotate 180°.
- Snap bracket back into channel.
- Attach reflector to brackets using #8 flat screws.

CHANGE DIRECTION OF THROW - UPLIGHT

- Remove screws in mounting rail. Rotate rail, reflector, and board assembly 180°.
- Attach mounting rail to extrusion with #8 flat screws.

DIRECTION OF THROW

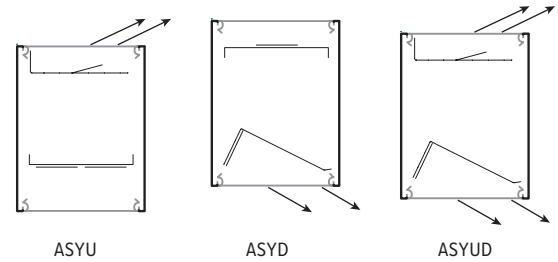

REVERSED DIRECTION OF THROW

