

CATALOG #: \_\_\_\_\_

TYPE: \_\_\_\_\_

PROJECT: \_\_\_\_\_



## FEATURES

- Round, suspended architectural fixture adds visual interest to a variety of applications
- Sleek aircraft cable or pendant mount
- Provides soft, uniform ambient illumination
- Lift-and-twist lens assembly allows for easy maintenance
- Efficacies up to 143 lm/W
- Wireless in-fixture control solutions available
- Made Right Here® in the USA

## SPECIFICATIONS

- HOUSING** – .080" spun aluminum outer housing with C.R.S. back plate.
- SHIELDING** – Frosted acrylic lens, .125" thick.
- FINISH** – Textured matte white polyester TGIC powder coat bonded to phosphate-free, multi-stage pretreated metal. All parts painted after fabrication to facilitate installation, increase efficiency, and inhibit corrosion.
- ELECTRICAL** – High-quality mid-power LED boards. L85 at 50,000 hours. 25°C maximum ambient operating temperature.
- MOUNTING** – Suspended. Adjustable steel aircraft cable mounts to 1/4-20 stud provided by others; or use 3/8" IPS stem and canopy kit.
- LISTINGS** –
  - cCSAus certified as luminaire suitable for dry or damp locations.
  - Complies with the Buy American Act and other federal regulations. Request certification at [hew.com/baa](http://hew.com/baa).
- WARRANTY** – 5-year limited warranty, see [hew.com/warranty](http://hew.com/warranty).

ORDERING EXAMPLE: RNDP - 4 - L200/835 - FXA - ACF\*4P/D24 - OPTIONS - CONTROL/DIM - UNV

## ORDERING INFO

SERIES	DIAMETER	LUMENS <sup>[1]</sup>	CRI	CCT	LENS
RNDP	2 2'	2'	8 80	27 2700K	FXA Frosted convex acrylic lens
	3 3'	L25 2,500lm	9 90 <sup>[2]</sup>	30 3000K	
	4 4'	L45 4,500lm		35 3500K	
		L83 8,300lm		40 4000K	
		3'		50 5000K	
		L67 6,700lm			
		L150 15,000lm			
	4'	L136 13,600lm			
		L200 20,000lm			

## MOUNTING AND POWER (EXAMPLE: ACF\*4P/D24) <sup>[3]</sup>

Prefix	Fixture Size	Type	Length
ACF*	3P/ 2' or 3' unit	D 1" grid & hardpan	24 24"
	4P/ 4' unit	N 9/16" grid	48 48"
		S Slot grid	96 96"

## OPTIONS

See page 3 for FINISH OPTIONS.

**EM/10WRM** Remote mount 10-watt emergency battery <sup>[4]</sup>  
**(L\_\_)** Additional lower lumen packages available. Specify in increments of 100 nominal lumens.  
**Example:** 9,500 nominal lumens = RNDP-4-L136/835-FXA-(L95)

## CONTROL

See page 4 for ADDITIONAL CONTROL/ DRIVER OPTIONS.

–	None
AVI-LVFA	Avi-on wireless fixture control <sup>[5]</sup>
AWN	Lutron Athena wireless node integral fixture control, RF only <sup>[6]</sup>

## DRIVER

See page 4 for ADDITIONAL CONTROL/ DRIVER OPTIONS.

<b>DIM</b>	Driver with external dimming wires
<b>DIM1</b>	1% Dimming driver, 0-10V
<b>DRV</b>	Driver without external dimming wires
<b>DA</b>	Driver with 12V auxiliary power, without external dimming wires <sup>[7]</sup>
<b>DSR</b>	Sensor-ready driver without external dimming wires (D4i DALI-2) <sup>[8]</sup>

## VOLTAGE

<b>120</b>	120V
<b>277</b>	277V
<b>UNV</b>	120-277V

## NOTES

- Nominal lumen output based on 80 CRI/3500K CCT. Actual performance may vary +/-5%, see page 2 for FIXTURE PERFORMANCE DATA. Additional lumen packages available, see options.
- Extended lead times may apply. Consult factory for availability.
- See page 3 for MOUNTING DETAILS.
- Requires remote mounted battery, provided with remote mounting enclosure for installation in ceiling above fixture. Separate power and control wiring to remote box required. See page 3 for MOUNTING DETAILS.

- DA Driver only. See page 4 for AVI-ON BLUETOOTH WIRELESS CONTROL DETAILS.
- DA and DSR Drivers only.
- Avi-on and Lutron Athena Controls only.
- Lutron Athena Controls only.



### FIXTURE PERFORMANCE DATA

	LED PACKAGE	DELIVERED LUMENS	WATTAGE	EFFICACY (lm/W)
2'	L25	2528	24.3	104
	L45	4530	45.7	99
	L83	8197	85.0	96
3'	L67	6717	57.9	116
	L150	15114	136.3	111
	L136	13649	95.4	143
4'	L200	20070	147.7	136

- Photometrics tested in accordance with IESNA LM-79. Results based on 80 CRI/3500K CCT, average wattage for 120V through 277V input, and 25°C ambient temperature. Actual performance may vary +/-5%.
- To calculate lumen output in emergency mode, multiply the battery wattage by the efficacy.
- Use multiplier table to calculate additional options.

### MULTIPLIER TABLES

COLOR TEMPERATURE		
	CCT	CONVERSION FACTOR
80 CRI	2700K	0.97
	3000K	0.99
	3500K	1.00
	4000K	1.03
	5000K	1.06
90 CRI	2700K	0.80
	3000K	0.82
	3500K	0.83
	4000K	0.86
	5000K	0.89

### PHOTOMETRY

**RNDP-2-L83/835-FXA** Total Luminaire Output: 8197 lumens; 85.0 Watts | Efficacy: 96.4 lm/W | 80.0 CRI; 3500K CCT

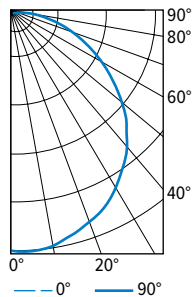

VERTICAL ANGLE	HORIZONTAL ANGLE			ZONAL LUMENS
	0°	45°	90°	
0	2844	2844	2844	
5	2860	2840	2827	270
15	2764	2754	2744	776
25	2558	2548	2551	1178
35	2272	2265	2252	1416
45	1922	1876	1889	1457
55	1463	1443	1453	1307
65	1004	1001	1004	992
75	555	559	539	584
85	186	176	183	216
90	76	83	86	

LUMEN SUMMARY	ZONE	LUMENS	% FIXTURE
	0 - 30	2224	27
	0 - 40	3640	44
	0 - 60	6405	78
	0 - 90	8197	100
	0 - 180	8197	100

**RNDP-3-L150/835-FXA** Total Luminaire Output: 15114 lumens; 136.3 Watts | Efficacy: 110.9 lm/W | 80.0 CRI; 3500K CCT

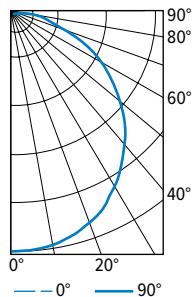

VERTICAL ANGLE	HORIZONTAL ANGLE			ZONAL LUMENS
	0°	45°	90°	
0	5225	5225	5225	
5	5206	5202	5204	495
15	5034	5050	5050	1424
25	4684	4695	4689	2161
35	4155	4146	4180	2602
45	3456	3490	3490	2690
55	2711	2704	2709	2418
65	1848	1871	1850	1841
75	988	1024	974	1061
85	322	329	307	376
90	123	129	120	

LUMEN SUMMARY	ZONE	LUMENS	% FIXTURE
	0 - 30	4080	27
	0 - 40	6682	44
	0 - 60	11790	78
	0 - 90	15068	100
	0 - 180	15114	100

**RNDP-4-L200/835-FXA** Total Luminaire Output: 20070 lumens; 147.7 Watts | Efficacy: 135.9 lm/W | 80.0 CRI; 3500K CCT

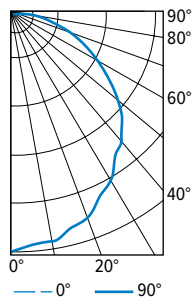

VERTICAL ANGLE	HORIZONTAL ANGLE			ZONAL LUMENS
	0°	45°	90°	
0	7356	7356	7356	
5	7102	7096	7090	678
15	6803	6794	6797	1924
25	6157	6149	6154	2858
35	5367	5357	5364	3388
45	4700	4691	4697	3574
55	3598	3592	3604	3188
65	2477	2464	2480	2432
75	1313	1316	1316	1430
85	467	475	475	547
90	185	188	188	

LUMEN SUMMARY	ZONE	LUMENS	% FIXTURE
	0 - 30	5461	27
	0 - 40	8849	44
	0 - 60	15611	78
	0 - 90	20019	100
	0 - 180	20070	100



# RNDP LED

## Round Architectural Pendant

### CROSS-SECTION

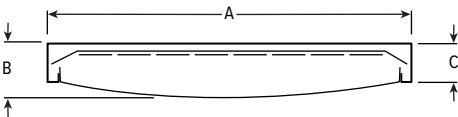

FIXTURE SIZE	A (DIA.)	B	C
2'	ø26-3/16"	6-11/16"	5-1/8"
3'	ø36-11/16"	7-3/16"	5-1/8"
4'	ø48-11/16"	7-11/16"	5-1/8"

### MOUNTING DETAILS

#### 2' MOUNTING INFORMATION

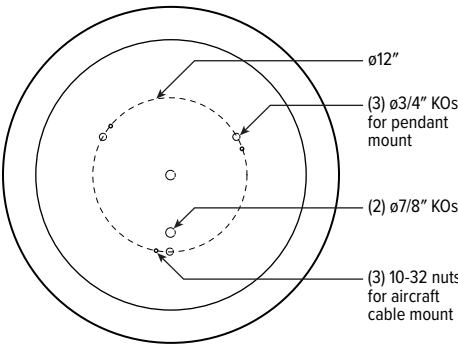

#### 4' MOUNTING INFORMATION

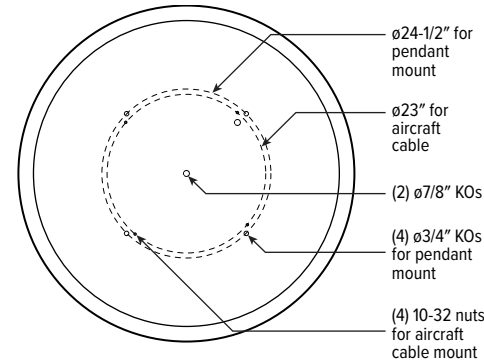

#### 3' MOUNTING INFORMATION

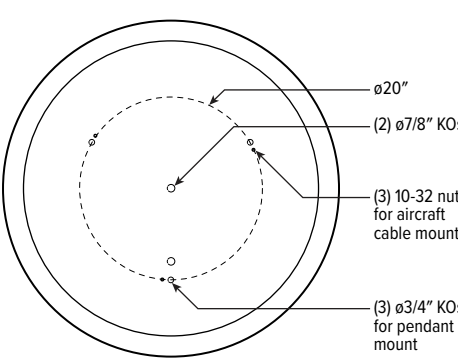

#### REMOTE MOUNT BATTERY

Max remote distance 50'.

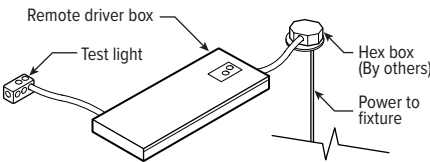

#### STANDARD MOUNTING HARDWARE

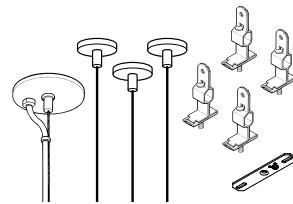

Fixtures are provided with:

- Adjustable length aircraft cables, must specify
- White cord, No. 18 AWG
- One 5" and two or three 2" canopies
- T-bar clips with 1/4-20 stud
- Hard ceiling anchor provided by others
- The feeder kits are standard with a 5" canopy to cover the junction box and a 2" canopy at the non-feed point. No J-box is required at non-feed points.

### FINISH OPTIONS

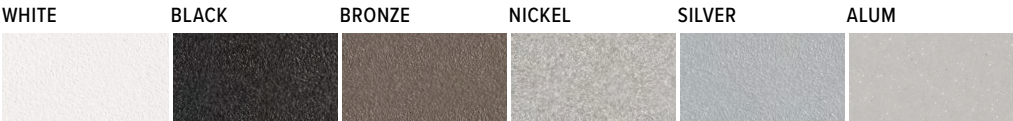

For custom color, please specify RAL code or a manufacturer code with description. All custom colors other than RAL require two sample swatches, minimum 1" square.



### AVI-ON BLUETOOTH WIRELESS CONTROL DETAILS

#### FEATURES

##### Simple

- Gateway-free distributed control
- Factory pre-commissioning
- Contractor friendly installation
- Occupancy/vacancy/daylight sensing

##### Scalable

- Virtually unlimited network size
- Spans small offices to large warehouses
- Flexible control strategies

##### Secure

- Optional cloud connectivity
- UL IoT platinum security rating
- DLC 5.0 compliant

#### COMMISSIONING & INSTALLATION TOOLS

Avi-on mobile apps provide intuitive, quick installation and commissioning. Pro tools are available to qualified installers. Live commissioning training and on-site or remote support by Avi-on must be ordered separately through Avi-on.

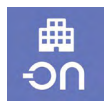

Commissioning  
Mobile App

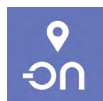

Zone Scanner  
Web App



Commissioning  
Pro App

#### SYSTEM COMPONENTS

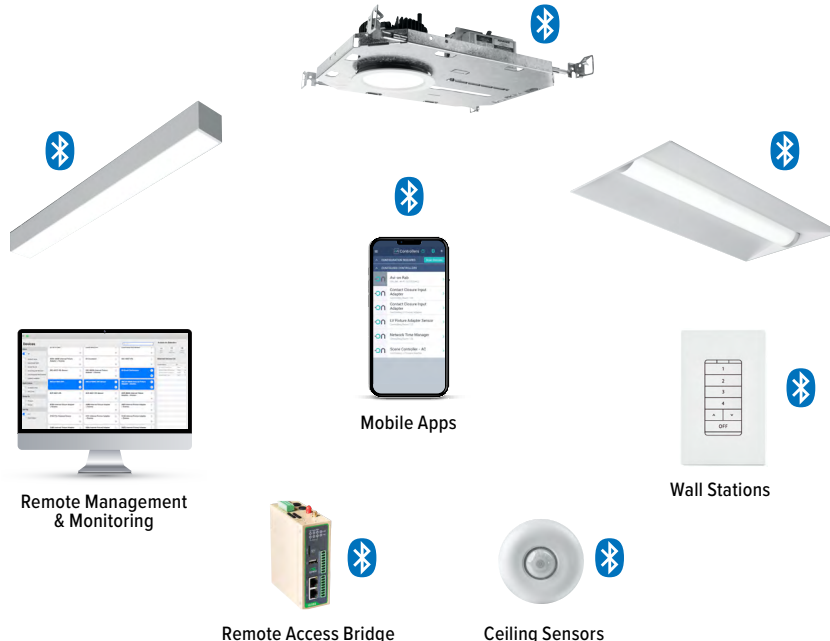

The Bluetooth® word mark and logos are registered trademarks owned by Bluetooth SIG, Inc. and any use of such marks by Avi-on is under license. Other trademarks and trade names are those of their respective owners.

#### ACCESSORIES

WALL STATIONS	
AVI-2401AC	Scene controller - numbered 1-4, 120-277VAC
AVI-2402BAT	Scene controller - numbered 1-4, battery powered
AVI-2401AC-2	Dimmer with presets - percentages, 120-277VAC
AVI-2402BAT-2	Dimmer with presets - percentages, battery powered
AVI-2401AC-3	On/off/dimming, 120-277VAC
AVI-2402BAT-3	On/off/dimming, battery powered

NETWORK	
AVI-RAB-LTE	Remote access bridge
AVI-KIT-NTM	Network time manager with battery backup
CEILING MOUNT SENSORS	
AVI-KIT-SEN-DUCM	PIR motion and ultrasonic sensor kit
AVI-KIT-SEN-ICM	PIR motion and photocell sensor kit

For load controllers and additional accessory info, see [hew.com/avi-on](http://hew.com/avi-on)

#### ADDITIONAL CONTROL/DRIVER OPTIONS

Note: Lumen restrictions apply, consult product builder at [hew.com/product-builder](http://hew.com/product-builder).

CATALOG NUMBER	DESCRIPTION
AVI-LVFA/DA	Avi-on wireless fixture control for use with driver with 12V auxiliary power
AWNDR/DA	Lutron Athena wireless node integral fixture control, RF only, for use with driver with 12V auxiliary power
AWNDR/DSR	Lutron Athena wireless node integral fixture control, RF only, for use with sensor-ready driver (D4i DALI-2)
DRV	Driver prewired for non-dimming applications
DIM	Dimming driver prewired for 0-10V low voltage applications
DIM1	1% dimming driver prewired for 0-10V low voltage applications
DIM LINE	Line voltage dimming driver (TRIAC and ELV compatible, 120V only)
DIM TRC	Line voltage dimming driver (TRIAC compatible, 120V only)
SD40	40% step-dimming driver
SD50	50% step-dimming driver
DALI	DALI dimming driver
LDE1	Lutron Hi-lume 1% EcoSystem dimming LED driver

