

CATALOG #: \_\_\_\_\_

TYPE: \_\_\_\_\_

PROJECT: \_\_\_\_\_



## FEATURES

- Sleek, slim architectural design provides direct or indirect light
- Slightly wrapped lens creates glowing edge and smooth illumination
- Attractive source of direct or indirect lighting for use in offices, hallways, conference rooms and medical facilities
- Wireless in-fixture control solutions available
- Made Right Here® in the USA

## SPECIFICATIONS

- HOUSING – Extruded aluminum.
- SHIELDING – Frosted acrylic lens.
- FINISH – Matte, smooth silver sparkle (ALUM) standard. All other colors default to textured finish. Polyester powder coat bonded to phosphate-free, multi-stage pretreated metal. All parts painted after fabrication to facilitate installation, increase efficiency, and inhibit corrosion.
- ELECTRICAL – High quality mid-power LED boards. L70 at 60,000 hours per IES TM-21.
- MOUNTING – Suspended. 1/16" diameter adjustable steel leveling aircraft cable and mounting hardware necessary for grid ceiling applications provided.
- LISTINGS –
  - cCSAus certified as luminaire suitable for dry or damp locations.
  - Complies with the Buy American Act and other federal regulations. Request certification at [hew.com/baa](http://hew.com/baa).
- WARRANTY – 5-year limited warranty, see [hew.com/warranty](http://hew.com/warranty).

ORDERING EXAMPLE: AX2U - 4 - L33/835 - S - AC/D48 - OPTIONS - CONTROL/DIM - UNV

## ORDERING INFO

SERIES	LENGTH	LUMENS <sup>[1]</sup>	CRI	CCT	FIXTURE TYPE
AX2D Down	2 2'	2'	8 80	27 2700K	F Electrical feeder unit <sup>[3]</sup>
AX2U Up	4 4'	L16 1,600lm	9 90 <sup>[2]</sup>	30 3000K	J Joiner unit <sup>[4]</sup>
	8 8'	4'		35 3500K	S Stand-alone unit <sup>[5]</sup>
		L33 3,300lm		40 4000K	
		8'		50 5000K	
		L66 6,600lm			

## MOUNTING (EXAMPLE: AC/D48)<sup>[6]</sup>

Prefix	Type	Length
AC/	D 1" grid & hardpan	24 24"
	N 9/16" grid	48 48"
	S Slot grid	96 96"

## OPTIONS

See page 3 for FINISH OPTIONS.

**EM/10WRM** Remote mount 10-watt emergency battery<sup>[7]</sup>  
 Additional lower lumen packages available.<sup>[8]</sup>  
 Example: 2,500 nominal lumens =  
 AX2U-4-L33/835-S-(L25)

## CONTROL<sup>[9]</sup>

See page 5 for ADDITIONAL CONTROL OPTIONS.

–	None
AVI-LVFA	Avi-on wireless fixture control <sup>[10]</sup>
AVI-LVFA-CS2-PIR	Avi-on wireless fixture control with PIR motion and daylight sensor <sup>[11]</sup>
AWNRR	Lutron Athena wireless node integral fixture control, RF only <sup>[12]</sup>
AWNS	Lutron Athena wireless node integral fixture control, RF with daylight and occupancy sensing <sup>[13]</sup>

## DRIVER

See page 5 for ADDITIONAL DRIVER OPTIONS.

<b>DIM</b>	Driver with external dimming wires
<b>DRV</b>	Driver without external dimming wires
<b>DA</b>	Driver with 12V auxiliary power, without external dimming wires <sup>[14]</sup>
<b>DSR</b>	Sensor-ready driver without external dimming wires (D4i DALI-2). <sup>[15]</sup>

## VOLTAGE

<b>120</b>	120V
<b>277</b>	277V
<b>UNV</b>	120-277V

## NOTES

- <sup>1</sup> Lumens based on 80 CRI/3500K CCT. Actual performance may vary +/-5%. Additional lumen packages available, see Options.
- <sup>2</sup> Extended lead times may apply. Consult factory for availability
- <sup>3</sup> 3-conductor straight white cord standard. Wire gauge to be determined by row length, quick-connect wiring harness, two end plates, field installed.
- <sup>4</sup> No cord, quick-connect wiring harness, no end plates.
- <sup>5</sup> 3-conductor straight white cord standard, two end plates installed.
- <sup>6</sup> See page 2 for MOUNTING DETAILS.
- <sup>7</sup> See page 2 for MOUNTING DETAILS.
- <sup>8</sup> Specify in increments of 100 nominal lumens. Option must be specified with next higher lumen package.

- <sup>9</sup> Sensor recommended for use in downlight orientation only. See page 4 for AVI-ON BLUETOOTH WIRELESS CONTROL DETAILS. See page 3 for SENSOR & NODE PLACEMENT DETAILS.
- <sup>10</sup> DA driver only.
- <sup>11</sup> DA driver only.
- <sup>12</sup> DA and DSR Drivers only.
- <sup>13</sup> DA and DSR Drivers only.
- <sup>14</sup> Avi-on and Lutron Athena Controls only.
- <sup>15</sup> Lutron Athena Controls only.



# AX2 LED 2" Suspended Architectural

## WATTAGE DETAILS

LED PACKAGE	
L16	18
L33	42
L66	83

## PHOTOMETRY

AX2U-4-L33/835-S-DIM-UNV Report #: 18753.0; 03/11/15 | Total Luminaire Output: 3248 lumens; 41.6 Watts | Efficacy: 78.2 lm/W | 84 CRI; 3483K CCT

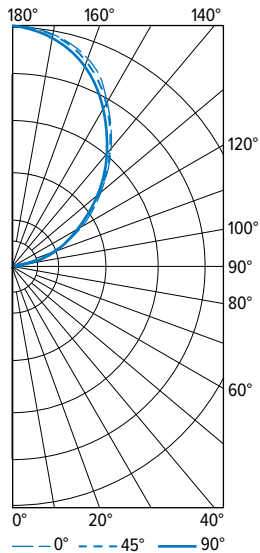

VERTICAL ANGLE	HORIZONTAL ANGLE			ZONAL LUMENS
	0°	45°	90°	
0	0	0	0	
5	0	0	0	0
15	0	0	0	0
25	0	0	0	0
35	0	0	0	0
45	0	0	11	2
55	0	8	19	8
65	0	13	28	13
75	0	20	40	21
85	1	26	47	27
90	9	37	63	
95	40	68	97	75
105	168	179	205	195
115	331	328	334	332
125	523	513	492	463
135	725	706	686	553
145	927	918	887	576
155	1123	1104	1082	511
165	1237	1229	1208	348
175	1293	1294	1288	124
180	1304	1304	1304	

LUMEN SUMMARY	ZONE	LUMENS	% FIXTURE
	0 - 30	0	0
	0 - 40	0	0
	0 - 60	10	0
	0 - 90	71	2
	90 - 120	603	19
	90 - 150	2194	68
	90 - 180	3177	98
	0 - 180	3248	100

## CROSS SECTIONS

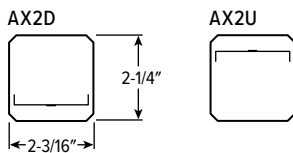

## MOUNTING DETAILS

### SIDE VIEW

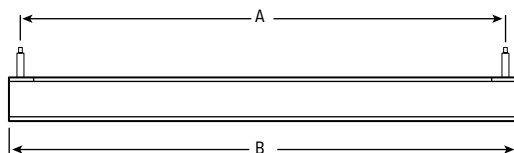

NOMINAL LENGTH	MOUNTING LENGTH (A)	ACTUAL LENGTH (B)
2'	24-5/8"	25-7/8"
4'	46-13/16"	48-1/16"
8'	89-7/8"	91-1/8"

### REMOTE MOUNT BATTERY

Max remote distance 50'.

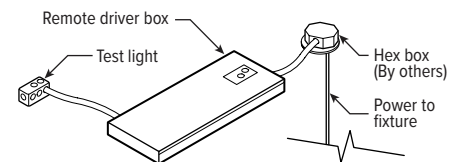

### CONTINUOUS ROW FIXTURES

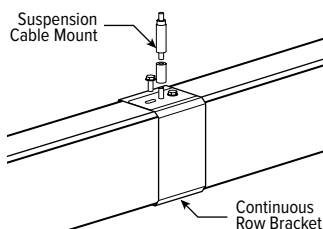

When row mounting fixtures, joint between fixtures will be visible at 4' or 8' intervals depending on fixture length.

### STANDARD HARDWARE FOR SUSPENDED PRODUCT (Grid and Hardpan)

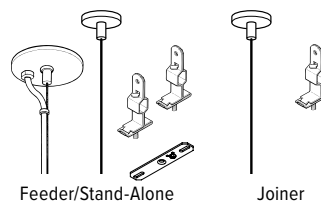

#### Notes:

- Fixtures are provided with adjustable length aircraft cables and mounting hardware, must specify.
- Electrical supply is brought into the feeder fixture, either as part of a row or as a stand-alone unit. Joiner fixtures complete the row.
- The feeder kits are standard with a 5" canopy to cover the junction box and a 2" canopy at the non-feed point. No J-box is required at non-feed points.







AX2

LED

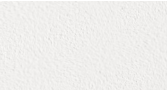
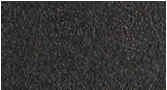
2" Suspended Architectural

FINISH OPTIONS

WHITE	BLACK	BRONZE	NICKEL	SILVER	ALUM
					

For custom color, please specify RAL code or a manufacturer code with description. All custom colors other than RAL require two sample swatches, minimum 1" square.

SENSOR & NODE PLACEMENT DETAILS

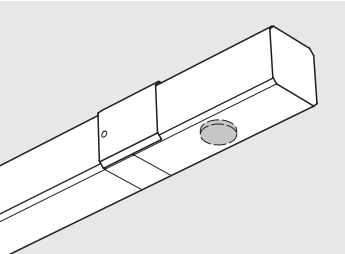

SEE NEXT PAGE FOR CONTROL DETAILS.

# AX2 LED 2" Suspended Architectural

## AVI-ON BLUETOOTH WIRELESS CONTROL DETAILS

### FEATURES

#### Simple

- Gateway-free distributed control
- Factory pre-commissioning
- Contractor friendly installation
- Occupancy/vacancy/daylight sensing

#### Scalable

- Virtually unlimited network size
- Spans small offices to large warehouses
- Flexible control strategies

#### Secure

- Optional cloud connectivity
- UL IoT platinum security rating
- DLC 5.0 compliant

### COMMISSIONING & INSTALLATION TOOLS

Avi-on mobile apps provide intuitive, quick installation and commissioning. Pro tools are available to qualified installers. Live commissioning training and on-site or remote support by Avi-on must be ordered separately through Avi-on.



Commissioning  
Mobile App



Zone Scanner  
Web App



Commissioning  
Pro App

### SYSTEM COMPONENTS

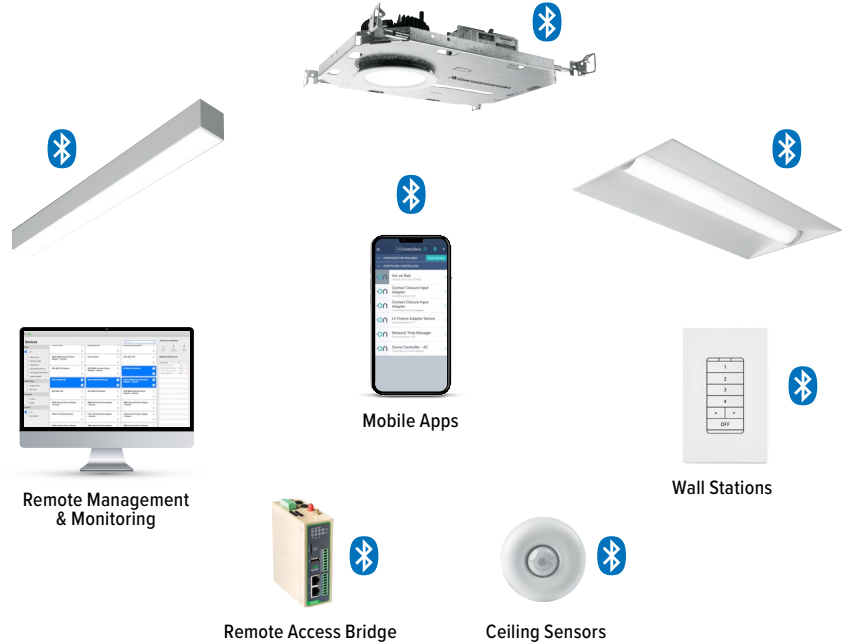

The Bluetooth® word mark and logos are registered trademarks owned by Bluetooth SIG, Inc. and any use of such marks by Avi-on is under license. Other trademarks and trade names are those of their respective owners.

### ACCESSORIES

WALL STATIONS	
AVI-2401AC	Scene controller - numbered 1-4, 120-277VAC
AVI-2402BAT	Scene controller - numbered 1-4, battery powered
AVI-2401AC-2	Dimmer with presets - percentages, 120-277VAC
AVI-2402BAT-2	Dimmer with presets - percentages, battery powered
AVI-2401AC-3	On/off/dimming, 120-277VAC
AVI-2402BAT-3	On/off/dimming, battery powered

NETWORK	
AVI-RAB-LTE	Remote access bridge
AVI-KIT-NTM	Network time manager with battery backup
CEILING MOUNT SENSORS	
AVI-KIT-SEN-DUCM	PIR motion and ultrasonic sensor kit
AVI-KIT-SEN-ICM	PIR motion and photocell sensor kit

For load controllers and additional accessory info, see [hew.com/avi-on](http://hew.com/avi-on)

### AVI-LVFA-CS2-PIR Avi-on wireless fixture control with PIR motion and daylight sensor. DA Driver only.

SPECIFICATIONS	
TYPE	PIR Motion + Daylight
MOUNTING HEIGHT	8' – 10'
DETECTION ANGLE	360°
TEMPERATURE RANGE	-30° to 50°C
RELATIVE HUMIDITY	10 to 80% non-condensing
IP RATING	IP20
MANUFACTURER	Avi-On

### SENSOR COVERAGE PATTERNS

#### Side View

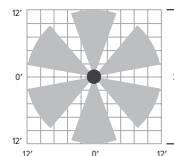
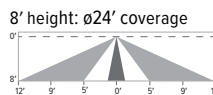

### SENSOR DETAIL



Dimensions: 13/16" x 2-1/4"



# AX2<sup>LED</sup> 2" Suspended Architectural

## ADDITIONAL CONTROL OPTIONS

**AWNS** Lutron Athena wireless node integral fixture control, RF with daylight and occupancy sensing. DA and DSR Drivers only.

SPECIFICATIONS	
TYPE	Radio Frequency
MOUNTING HEIGHT	8' – 12'
DETECTION ANGLE	360°
TEMPERATURE RANGE	0° to 55°C
RELATIVE HUMIDITY	0 to 90%, non-condensing
COMMISSIONING	Clear Connect gateway – Type X with app (iOS or Android)
MANUFACTURER	Lutron
	

### SENSOR COVERAGE PATTERNS

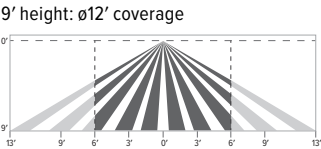

### Motion Sensor Coverage

CEILING HEIGHT	COVERAGE AREA (SQ FT)
8'	114
9'	144
10'	178
12'	256

### SENSOR DETAIL



Dimensions: ø1-1/8"

## ATHENA CONTROL OPTIONS

CATALOG NUMBER	DESCRIPTION
AWNDR	Lutron Athena wireless node integral fixture control, RF only, for use with D4i DALI-2 or driver with 12V auxiliary power.
AWNS	Lutron Athena wireless node integral fixture control, RF with daylight and occupancy sensing, for use with D4i DALI-2 or driver with 12V auxiliary power.
AWNDR-BL	Lutron Athena wireless node integral fixture control, RF only, for use with D4i DALI-2 or driver with 12V auxiliary power, black finish.
AWNS-BL	Lutron Athena wireless node integral fixture control, RF with daylight and occupancy sensing, for use with D4i DALI-2 or driver with 12V auxiliary power, black finish.

## ADDITIONAL DRIVER OPTIONS

Note: Lumen restrictions apply, consult product builder at [hew.com/product-builder](http://hew.com/product-builder).

CATALOG NUMBER	DESCRIPTION
DRV	Driver prewired for non-dimming applications
DIM	Dimming driver prewired for 0-10V low voltage applications
DIM1	1% dimming driver prewired for 0-10V low voltage applications
DIM LINE	Line voltage dimming driver (TRIAC and ELV compatible, 120V only)
DIM TRC	Line voltage dimming driver (TRIAC compatible, 120V only)
DA	Driver with 12V auxiliary power
DSR	Sensor-ready driver (D4i DALI-2)
SD40	40% step-dimming driver
SD50	50% step-dimming driver
DALI	DALI dimming driver
LDE1	Lutron Hi-lume 1% EcoSystem dimming LED driver

