

6AR PoE | tunable WHITE 6" Adjustable Downlight – Round

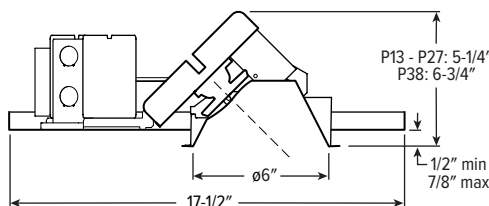

CATALOG #: _____

TYPE: _____

PROJECT: _____

NEW CONSTRUCTION AND REMODEL

FEATURES

- Deliver scalable, data-driven smart buildings with PoE-enabled fixtures and controls



SPECIFICATIONS

- HOUSING** – Die-cast aluminum spun and stamped articulating mechanism with forged aluminum heat sink. Galvanized steel splice compartment with driver mounting plate/enclosure. Mounting clips allow for ceiling thickness from 1/2" - 7/8".
- OPEN REFLECTOR** – Low-iridescent anodized aluminum. Clear semi-specular finish standard.
- LENSED TRIM** – Die-cast aluminum frame with micro-prismatic, acrylic lens.
- ELECTRICAL** – High-performance Class 2 LED array. Modular quick-connect plug for easy field-connection of LED light assembly to driver. Reported L70>50,000 hours. Low-voltage DC fixture, to be fed by Class 2 power supply. Tunable White products use LEDs of multiple CCTs and may produce a perceptibly different shade of white from single-CCT products at the same CCT. All CCTs are within 3 MacAdam ellipses.
- MOUNTING** – Recessed. 20 ga. galvanized steel mounting pan for new construction or IC-rated enclosure. Remodel kit option includes receiver bracket hardware. N and R mounting types for use in non-fire rated installations only. Minimum 24" O.C. marked spacing required for P38 lumen package.
- LISTINGS** –
 - cCSAus conforms to UL STD 1598; Certified to CAN/CSA STD C22.2 No. 250.0 for dry and damp locations. LED light assembly conforms to UL 2108 for remote installation.
 - Suitable for wet location under covered ceiling when specified with WET/CC option.
 - IC-rated for direct contact with insulation when specified with I Mounting Type.
 - City of Chicago Environmental Air approved when specified with CP option.
 - Complies with ASTM-E283 when specified with ATH option.
 - RoHS compliant.
 - Complies with the Buy American Act and other federal regulations. Request certification at hew.com/baa.
- WARRANTY** – 5-year limited warranty, see hew.com/warranty.

SYSTEM REQUIREMENTS

- PoE-ready luminaires are connected to building power systems through network integration and require other components for complete PoE lighting system
- For additional PoE info, see hew.com/poe

ORDERING EXAMPLE: 6AR - P27/835 - OPTIONS - POE PR - OW - OF - CS - TRIM OPTIONS - N - F1

HOUSING

| SERIES | LUMENS ^[1] | CRI | CCT | OPTIONS | CONTROL ^[2] |
|--------|----------------------------|---------------------|--|--|----------------------------------|
| 6AR | P13 1,300lm | 8 80 | 27 2700K | ATH Airtight construction ^[5] | POE PR Power over Ethernet-ready |
| | P27 2,700lm | 9 90 ^[4] | 30 3000K | CP Chicago plenum (CCEA) ^[6] | |
| | P38 3,800lm ^[3] | | 35 3500K | | |
| | | | 40 4000K | | |
| | | | 50 5000K | | |
| | | | TW Tunable white (80 CRI, 2700K–5000K) | | |

TRIM ^[7]

| TRIM TYPE | DISTRIBUTION ^[8] | FLANGE TYPE | REFLECTOR FINISH | TRIM OPTIONS |
|------------------|-----------------------------|---------------------------------------|------------------------------------|---|
| O Open reflector | W Wide | OF 1/2" standard flange | Open trim types | MWT Textured white trim flange ^[11] |
| L Flush lens | 55° Open | SF 1/4" mud-in flange ^[10] | CS Clear semi-specular anodize | AD Diffuse acrylic lens ^[12] |
| A Angled lens | 55° Flush | | WH White texture powder coat | PD Diffuse 1/8" polycarbonate lens ^[13] |
| | 50° Angled | | BL Black texture powder coat | WET/CC Wet location, covered ceiling listed ^[14] |
| | M Medium | | Lens trim types | AM Anti-microbial ^[15] |
| | 35° Open | | CS Clear semi-specular powder coat | |
| | 35° Flush | | WH White texture powder coat | |
| | 35° Angled | | BL Black texture powder coat | |
| | N Narrow ^[9] | | | |
| | 25° Open | | | |
| | 25° Flush | | | |
| | 30° Angled | | | |

MOUNTING

MOUNTING TYPE ^[16]

- N Open pan for new construction
- I IC-rated enclosure for new construction ^[18]
- R Remodel kit ^[19]

MOUNTING HARDWARE ^[17]

- F1 Factory-installed 2-position fixed pan bracket, universal bar hanger included ^[20]
- BA1 Adjustable butterfly pan bracket, bar hanger not included ^[21]
- CA1 Adjustable caterpillar pan bracket, universal bar hanger included ^[22]

NOTES

- Static white lumen output based on O trim type, W distribution and CS finish, 80 CRI, 3000K for single CCT and 4000K for TW. Actual lumens may vary +/-5%. See page 2 for FIXTURE PERFORMANCE DATA.
- For additional PoE connection details, consult factory.
- N Mounting Type only. Not available with Tunable White.
- Extended lead times may apply. Consult factory for availability. Not available with Tunable White.
- I Mounting Type required.
- I Mounting Type required. P27 lumen package max.
- Trim ships separately.
- Beam angle based on CS or WH reflector finish.
- Not available with Tunable White when specified with O Trim Type.
- For use with mud-in plaster construction only, supplied with mud flange installation kit. See page 3 for FLANGE TYPE DETAILS. Not available with ATH option.

- Not available with WH Reflector Finish or L Trim Type.
- L and A Trim Types only. W distribution only.
- L and A Trim Types only. W distribution only.
- L and A Trim Types only. Not available with PD trim option.
- WH and BL Reflector Finishes only.
- Mounting hardware required (N and I only), ordered separately, see MOUNTING HARDWARE ordering info. See page 4 for MOUNTING TYPE DETAILS.
- Additional mounting hardware options available. See page 5 for MOUNTING HARDWARE DETAILS.
- Not available with P38 lumen package.
- Also used in new construction sheetrock ceilings. Pan-less installation. P27 lumen package max.
- N and I Mounting Types only. Universal bar hanger ships uninstalled. I Mounting requires external brackets.
- N Mounting Type only.
- N Mounting Type only.



6AR PoE | tunable WHITE

6" Adjustable Downlight – Round

FIXTURE PERFORMANCE DATA

STANDARD

OPEN REFLECTOR TRIM TYPE

| | DISTRIBUTION | DELIVERED LUMENS | WATTAGE | EFFICACY (lm/W) |
|-----|--------------|------------------|---------|-----------------|
| P13 | W | 1305 | 12.3 | 106 |
| | M | 1308 | 12.3 | 106 |
| | N | 1308 | 12.3 | 106 |
| P27 | W | 2651 | 25.0 | 106 |
| | M | 2658 | 25.0 | 106 |
| | N | 2657 | 25.0 | 106 |
| P38 | W | 3792 | 37.5 | 101 |
| | M | 3789 | 37.5 | 101 |
| | N | 3627 | 37.5 | 97 |

FLUSH LENS TRIM TYPE

| | DISTRIBUTION | DELIVERED LUMENS | WATTAGE | EFFICACY (lm/W) |
|-----|--------------|------------------|---------|-----------------|
| P13 | W | 1146 | 12.3 | 93 |
| | M | 1223 | 12.3 | 99 |
| | N | 1216 | 12.3 | 99 |
| P27 | W | 2328 | 25.0 | 93 |
| | M | 2485 | 25.0 | 99 |
| | N | 2471 | 25.0 | 99 |
| P38 | W | 3326 | 37.5 | 89 |
| | M | 3531 | 37.5 | 94 |
| | N | 3391 | 37.5 | 90 |

ANGLED LENS TRIM TYPE

| | DISTRIBUTION | DELIVERED LUMENS | WATTAGE | EFFICACY (lm/W) |
|-----|--------------|------------------|---------|-----------------|
| P13 | W | 952 | 12.3 | 77 |
| | M | 1137 | 12.3 | 92 |
| | N | 1161 | 12.3 | 94 |
| P27 | W | 1934 | 25.0 | 77 |
| | M | 2310 | 25.0 | 92 |
| | N | 2358 | 25.0 | 94 |
| P38 | W | 2786 | 37.5 | 74 |
| | M | 3258 | 37.5 | 87 |
| | N | 3173 | 37.5 | 85 |

MULTIPLIER TABLES

| COLOR TEMPERATURE | | | |
|-------------------|-------|----------|---------------|
| | CCT | LUMENS | |
| | | STANDARD | TUNABLE WHITE |
| 80 CRI | 2700K | 0.92 | 0.83 |
| | 3000K | 0.98 | 1.00 |
| | 3500K | 1.00 | 0.99 |
| | 4000K | 1.01 | 1.00 |
| | 5000K | 1.02 | 0.98 |
| 90 CRI | 2700K | 0.76 | – |
| | 3000K | 0.79 | – |
| | 3500K | 0.82 | – |
| | 4000K | 0.84 | – |
| | 5000K | 0.88 | – |

| OPEN REFLECTOR FINISH | |
|-----------------------|-------------------|
| CATALOG NUMBER | CONVERSION FACTOR |
| CS | 1.00 |
| WH | 0.89 |
| BL | 0.79 |

| TRIM | |
|-----------------|-------------------|
| CATALOG NUMBER | CONVERSION FACTOR |
| AD ¹ | 0.85 |
| PD ¹ | 0.85 |

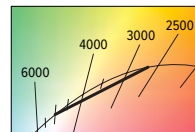

- ¹ Distribution will also be affected, consult factory.
- Photometrics tested in accordance with IESNA LM-79. Results shown are based on 25°C ambient temperature.
 - Standard results based on 3500K/80 CRI, 0° tilt, actual lumens may vary +/-5%
 - Tunable white results based on 4000K/80 CRI, 0° tilt, actual lumens may vary +/-5%
 - Use multiplier tables to calculate additional options.



6AR PoE | tunable WHITE 6" Adjustable Downlight – Round

PHOTOMETRY

6AR-P27-835-POE PR-OW-OF-WH (25° tilt) Total Luminaire Output: 2634 lumens; 25.0 Watts | Efficacy: 105.4 lm/W | 80 CRI; 3500K CCT

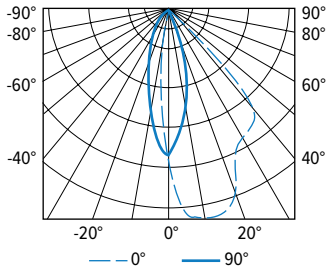

| CANDLEPOWER DISTRIBUTION | VERTICAL ANGLE | HORIZONTAL ANGLE | | | | | ZONAL LUMENS |
|--------------------------|----------------|------------------|------|------|------|------|--------------|
| | | 0° | 45° | 90° | 135° | 180° | |
| | 0 | 3480 | 3480 | 3480 | 3480 | 3480 | |
| | 5 | 4862 | 4286 | 3083 | 2147 | 1733 | 289 |
| | 15 | 5090 | 3800 | 1765 | 591 | 414 | 627 |
| | 25 | 3900 | 3397 | 723 | 163 | 123 | 729 |
| | 35 | 3463 | 2549 | 146 | 35 | 27 | 671 |
| | 45 | 2265 | 283 | 15 | 8 | 8 | 301 |
| | 55 | 27 | 3 | 0 | 0 | 3 | 16 |
| | 65 | 0 | 0 | 0 | 0 | 0 | 0 |
| | 75 | 0 | 0 | 0 | 0 | 0 | 0 |
| | 85 | 0 | 0 | 0 | 0 | 0 | 0 |
| | 90 | 0 | 0 | 0 | 0 | 0 | |

| LUMEN SUMMARY | ZONE | LUMENS | % FIXTURE |
|---------------|---------|--------|-----------|
| | 0 - 30 | 1645 | 63 |
| | 0 - 40 | 2317 | 88 |
| | 0 - 60 | 2634 | 100 |
| | 0 - 90 | 2634 | 100 |
| | 0 - 180 | 2634 | 100 |

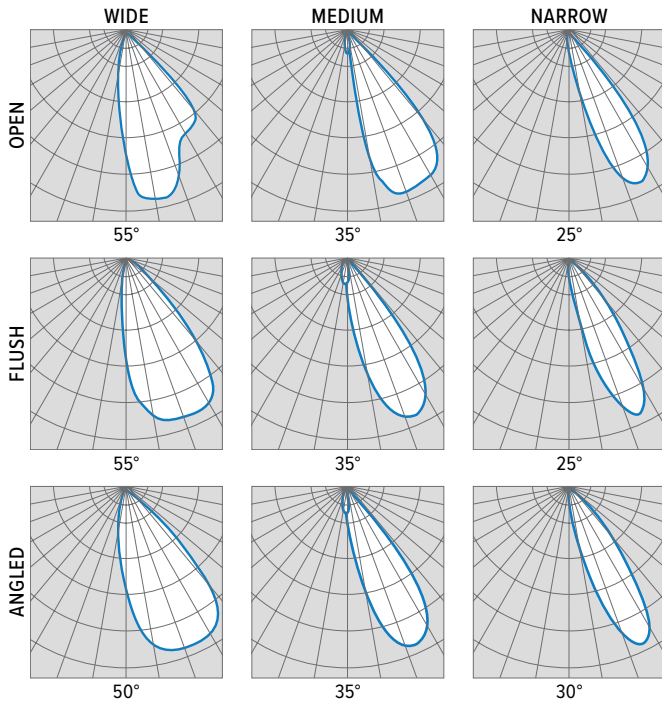

TRIM TYPE DETAILS

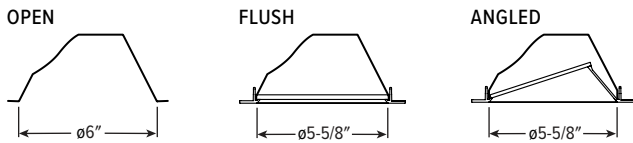

FLANGE TYPE DETAILS

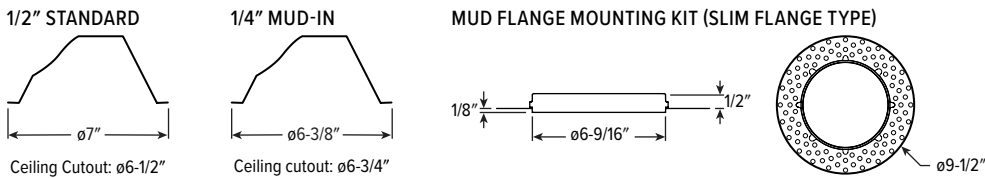

H.E. Williams, Inc.

Carthage, Missouri

www.hew.com

417-358-4065

Designed and Manufactured in the USA

Information contained herein is subject to change without notice.

REV.10/04/23.LA

Downlights
Page 3 of 5

6AR PoE | tunable WHITE

6" Adjustable Downlight – Round

REFLECTOR FINISH DETAILS



MOUNTING TYPE DETAILS

NEW CONSTRUCTION

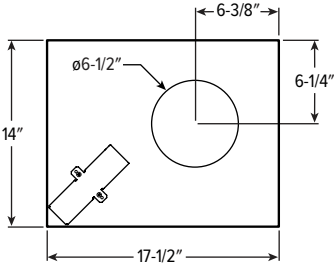

IC-RATED

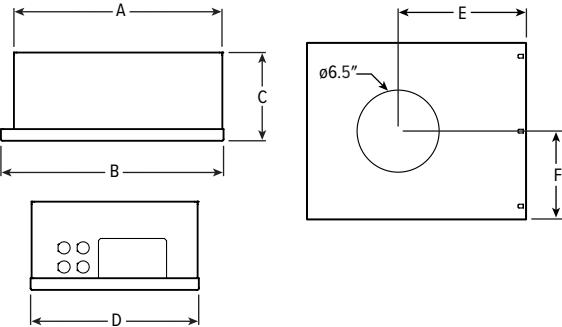

| LUMENS | LENGTH | | | | | |
|--------|----------|---------|--------|---------|---------|---------|
| | A | B | C | D | E | F |
| P13 | 15-3/16" | 16" | 6-3/8" | 12-1/8" | 9-1/2" | 6-1/16" |
| P27 | 16-5/8" | 17-1/2" | 7-7/8" | 14" | 10-1/4" | 7" |

REMODEL

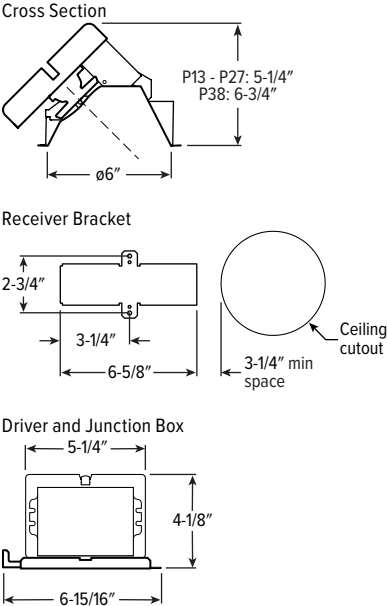

APERTURE ADAPTOR ORDERING INFO

| ORDERING EXAMPLE: 4DR - GR - 0575 - WHT | | | |
|---|---------------------------------|---|------------------------------------|
| SERIES | CATALOG NUMBER | CEILING CUTOUT | FINISH |
| 4AR 4DR 4DS 4PR 4PS 8DR | 6AR 6DR 6DS 6PR 6PS | GR Specify ceiling cutout in 1/8" increments. Example: 5.75" = 0575 See Kit Components for application limits. | CS Clear semi-specular powder coat |
| | | | WH White texture powder coat |
| | | | BL Black texture powder coat |

For use with remodel downlights. Additional finishes available, consult factory.
For limitations and instructions, see hew.com/aperture-adaptor.pdf

6AR PoE | tunable WHITE

6" Adjustable Downlight – Round

MOUNTING HARDWARE DETAILS

F1 Factory-installed 2-position fixed pan bracket, universal bar hanger included, ships uninstalled

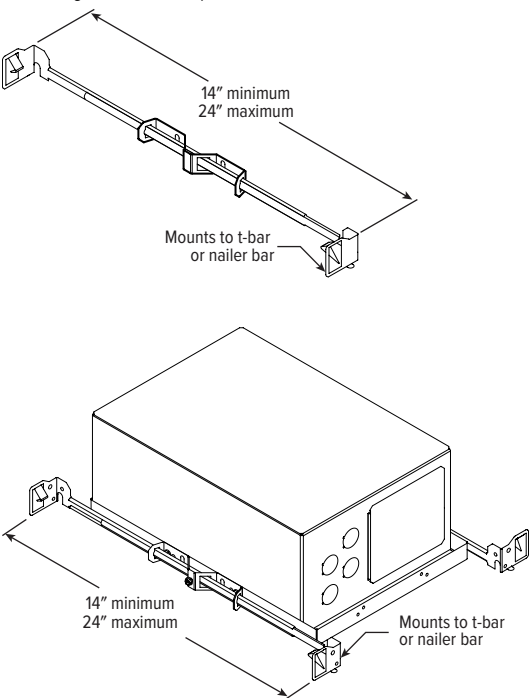

F1 with I Mounting Type

BA1 Adjustable butterfly pan bracket, bar hanger not included (N Mounting Type only)

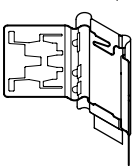

BA2 Adjustable butterfly pan bracket, heavy-duty universal bar hanger included (N Mounting Type only)

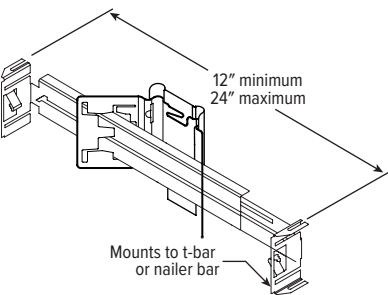

CA1 Adjustable caterpillar pan bracket, universal bar hanger included (N Mounting Type only)

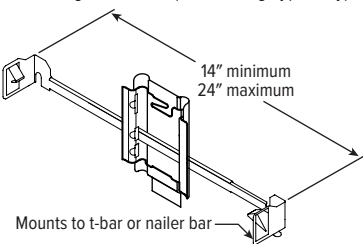

CA2 Adjustable caterpillar pan bracket, t-bar hanger included (N Mounting Type only)

