

4DR dim to **WARM** 4.5" Downlight – Round

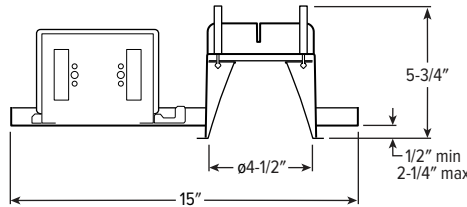

CATALOG #: _____

TYPE: _____

PROJECT: _____

NEW CONSTRUCTION AND REMODEL

ORDERING EXAMPLE: **4DR - TL - L24/9DW - OPTIONS - DIM1 - UNV - OW - OF - CS - TRIM OPTIONS - N - F1**



HOUSING

SERIES	LUMENS ^[1]	COLOR	OPTIONS	CONTROL	VOLTAGE
4DR - TL	L8 800lm	9DW Dim to warm (95 CRI, 1800K – 3000K)	See page 3 for EMERGENCY BATTERY OPTIONS .	DIM1 1% dimming driver (0-10V signal to control dimming and CCT)	UNV 120-277V
TrimLock	L15 1,500lm		SCA_ Sloped ceiling adapter ^[2]	LUT Lutron Ecosystem enabled ^[5]	347 347V ^[6]
	L24 2,400lm		ATH Airtight construction		
			F Fuse		
			CP Chicago plenum (CCEA) ^[3]		
			SDT Stepdown transformer ^[4]		

TRIM ^[7]

TRIM TYPE	DISTRIBUTION ^[8]	FLANGE TYPE	REFLECTOR FINISH	TRIM OPTIONS
O Open reflector	W Wide	OF 1/2" standard flange	Open trim types	MWT Textured white trim flange ^[14]
L Flush lens	65° Open	SF 1/4" mud-in flange ^[12]	CS Clear semi-specular anodize	IP IP65 rated trim ^[15]
R Regressed lens	50° Flush		SG Satin-glow anodize	AD Diffuse acrylic lens ^[16]
A Angled lens ^[9]	50° Regressed		GD Gold anodize	PD Diffuse 1/8" polycarbonate lens ^[17]
S Non-conductive flush lens for shower applications ^[10]	M Medium		CG Champagne gold anodize	TD Diffuse polycarbonate lens media at top of open reflector ^[18]
	45° Open		PW Pewter anodize	WET/CC Wet location, covered ceiling listed ^[19]
	35° Flush		SPC Clear specular anodize	AM Anti-microbial ^[20]
	30° Regressed		RG Rose gold anodize	
	N Narrow		WH White texture powder coat	
	10° Open		BL Black texture powder coat	
	25° Flush		Lens trim types	
	25° Regressed		CS Clear semi-specular powder coat	
	WW Wall wash ^[11]		WH White texture powder coat	
			BL Black texture powder coat	
			MB Black texture splay with white flange ^[13]	

MOUNTING

MOUNTING TYPE ^[21]	MOUNTING HARDWARE ^[22]
N Open pan for new construction	F1 Integral 2-position fixed pan bracket, universal bar hanger included ^[25]
I IC-rated enclosure for new construction ^[23]	BA1 Adjustable butterfly pan bracket, bar hanger not included ^[26]
R Remodel kit ^[24]	CA1 Adjustable caterpillar pan bracket, universal bar hanger included ^[27]

NOTES

- Lumen output based on full light output, O trim type, W distribution and CS finish, 3500K/95CRI. Actual lumens may vary +/-5%, see page 2 for FIXTURE PERFORMANCE DATA.
- 9" aperture, specify degrees of slope in 5° increments, 05°-30°. Not available with I Mounting Type, S Trim Type, ATH, IP, or WET/CC Options. Painted white. Other colors available, consult factory. See page 4 for SLOPED CEILING ADAPTOR DETAILS.
- I Mounting Type required.
- May be required for 347V, see product builder at hew.com/product-builder.
- Not available with I Mounting Type.
- Not available with EM batteries.
- Trim ships separately.
- Beam angle based on CS or WH reflector finish.
- Available with WW Distribution only.
- W Distribution, OF Flange Type, WH Reflector Finish only. Standard with AD diffuse acrylic lens. IP and WET/CC options standard.
- O and A Trim Types only.
- For use with mud-in plaster construction only, supplied with mud flange installation kit. See page 4 for FLANGE TYPE DETAILS. Not available with ATH or IP options.
- R Trim Type only. Not available with MWT.
- Not available with WH Reflector Finish, L or S Trim Types.
- L and R Trim Types only.
- Not available with O trim type. W and WW distributions only.
- Not available with O trim type. W and WW distributions only.
- O Trim Type only. WET/CC standard unless ordered with EM/RTS.
- Not available with PD trim option.
- Not available with S Trim Type. WH and BL Reflector Finishes only.
- Mounting hardware required (N and I only), ordered separately, see MOUNTING HARDWARE ordering info. See page 5 for MOUNTING TYPE DETAILS.
- Additional mounting hardware options available. SEE PAGE 5 FOR MOUNTING HARDWARE DETAILS.
- L8 and L15 lumen packages only. Not available with EM batteries.
- Also used in new construction sheetrock ceilings. Pan-less installation.
- N and I Mounting Types only. I Mounting requires external brackets.
- N Mounting Type only.
- N Mounting Type only.

4DR dim to WARM 4.5" Downlight – Round

FEATURES

TrimLock®

- Innovative TrimLock reflector retention system ensures trim remains flush with ceiling plane
- Mimic the comfortable, welcoming glow of incandescent with warm-dimming technology
- 4 inch aperture is unobtrusive in small scale spaces
- Die-cast trim choices include flush, regressed or angled lens
- Contemporary design provides glare-free illumination for a soft ceiling appearance
- Fully room-side accessible
- New construction mounting pan, IC-rated, or pan-less remodel kit available
- Sloped adapter accommodates vaulted ceilings
- Open reflector with nine finishes complements any interior style
- Optional non-conductive lens for shower applications

SPECIFICATIONS

- **HOUSING** – Die-cast aluminum trim housing with forged aluminum heat sink. Galvanized steel splice compartment with driver mounting plate/enclosure. Swing-out mounting arms field adjust for ceiling thickness from 1/2" – 2-1/4".
- **TRIMLOCK** – Innovative TrimLock reflector retention system ensures the trim remains flush with the ceiling plane.
- **OPEN REFLECTOR** – Low-iridescent anodized aluminum. Clear semi-specular finish standard.
- **LENSED TRIM** – Die-cast aluminum frame with micro-prismatic, acrylic lens.
- **ELECTRICAL** – High-performance Class 2 C.O.B. LED array. Modular quick-connect plug for easy field-connection of LED light assembly to driver. Reported L70>55,000 hours. Reported L90>55,000 hours. Estimated L70 = 200,000 hours.
- **MOUNTING** – Recessed. 20 ga. galvanized steel mounting pan for new construction or IC-rated enclosure. Remodel kit option includes receiver bracket hardware.

- **LISTINGS** –
 - cCSAus conforms to UL STD 1598; Certified to CAN/CSA STD C22.2 No. 250.0 for dry and damp locations. LED light assembly conforms to UL 2108 for remote installation.
 - Suitable for wet location under covered ceiling when specified with WET/CC or TD options.
 - IC-rated for direct contact with insulation when specified with I Mounting Type.
 - City of Chicago Environmental Air approved when specified with CP option.
 - Complies with ASTM-E283 when specified with ATH option.
 - RoHS compliant.
 - Complies with the Buy American Act and other federal regulations. Request certification at hew.com/baa.
- **WARRANTY** – 5-year limited warranty, see hew.com/warranty.

FIXTURE PERFORMANCE DATA

					OPEN REFLECTOR		FLUSH LENS		REGRESSED LENS	
	CCT AT 100% (FULL OUTPUT)	CCT AT 1% (FULL DIM)	DIST.	WATTAGE	DELIVERED LUMENS	EFFICACY (lm/W)	DELIVERED LUMENS	EFFICACY (lm/W)	DELIVERED LUMENS	EFFICACY (lm/W)
L8	3000K	1800K	W	14.0	862	62	670	48	678	48
			M	14.0	830	59	760	54	763	55
			N	14.0	800	57	765	55	769	55
L15			W	23.4	1511	65	1175	50	1188	51
			M	23.4	1455	62	1333	57	1337	57
			N	23.4	1402	60	1242	53	1348	58
L24			W	37.7	2228	59	1925	51	1945	52
			M	37.7	2226	59	1995	53	1997	53
			N	37.7	2228	59	2197	58	2208	59

¹ Distribution will also be affected, consult factory.

² Use multiplier when specified with O Trim Type.

• Photometrics tested in accordance with IESNA LM-79. Results shown are based on 25°C ambient temperature.

• Wattage shown is based on 120V input.

• Results based on 3000K, 95 CRI, full output, actual lumens may vary +/-5%

• To calculate lumen output in emergency mode, multiply the battery wattage by the efficacy.

• Use multiplier table to calculate additional options.

MULTIPLIER TABLES

	REFLECTOR FINISH	
	CATALOG NUMBER	CONVERSION FACTOR
O TRIM	CS	1.00
	SG ¹	0.92
	GD	0.93
	CG	0.96
	PW	0.86
	SPC	1.02
	RG	0.88
	WH ¹	0.89
R TRIM	BL ¹	0.47
	WH	1.00
	CS	0.98
	BL	0.79

TRIM	
CATALOG NUMBER	CONVERSION FACTOR
S	0.85
AD	0.85
PD	0.85
TD	0.75
WET/CC ²	0.85

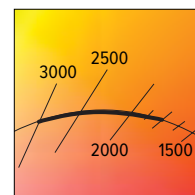

PHOTOMETRY

4DR-TL-L24/9DW-DIM1-UNV-OW-OF-CS Total Luminaire Output: 2228 lumens; 37.7 Watts | Efficacy: 59 lm/W | 95.0 CRI; 3000K CCT

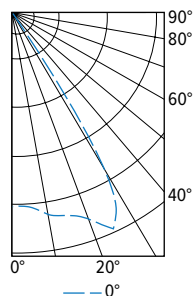

	VERTICAL ANGLE	HORIZONTAL ANGLE	ZONAL LUMENS
		0°	
CANDLEPOWER DISTRIBUTION	0	2011	
	5	2071	198
	15	2178	617
	25	2479	1147
	35	341	215
	45	49	38
	55	12	11
	65	1	1
	75	0	0
	85	0	0
	90	0	

LUMEN SUMMARY	ZONE	LUMENS	% FIXTURE
	0 - 40	2176	98
	0 - 60	2226	100
	0 - 90	2228	100
	0-180	2228	100



4DR dim to WARM

4.5" Downlight – Round

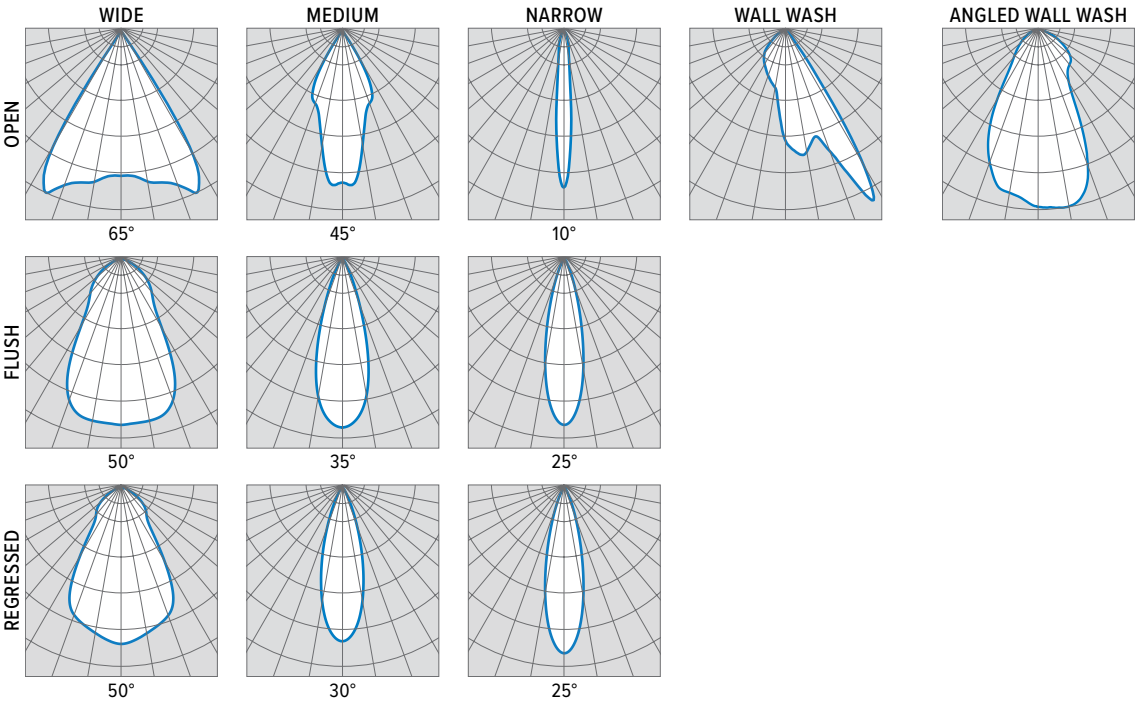

EMERGENCY BATTERY OPTIONS

Additional limitations apply, see page 1. Specify CEC in the option code when California Energy Commission regulations are required.

CATALOG NUMBER	DESCRIPTION
EM/7W	7-watt emergency battery ^[1]
EM/7W/RTS	7-watt emergency battery with regressed test switch ^[2]
EM/7W/IPRTS	7-watt emergency battery with IP65 rated regressed test switch
EM/10W	10-watt emergency battery ^[1]
EM/10W/RTS	10-watt emergency battery with regressed test switch ^[2]
EM/10W/IPRTS	10-watt emergency battery with IP65 rated regressed test switch

- ¹ Not available with S Trim Type or IP Option.
- ² Not available with S Trim Type, IP or WET/CC Options.

REGRESSED TEST SWITCH DETAILS

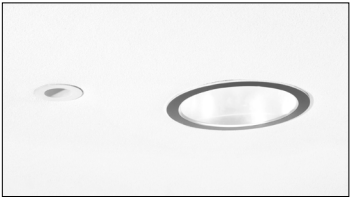

Shown Installed

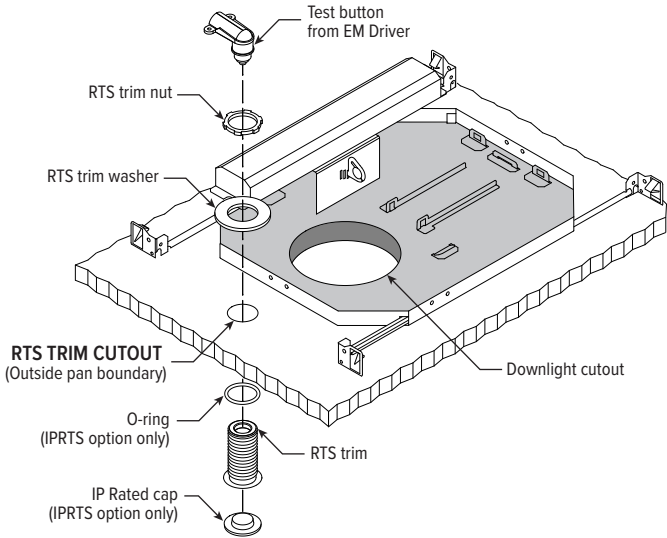

4DR dim to **WARM** 4.5" Downlight – Round

TRIMLOCK DETAILS



SLOPED CEILING ADAPTOR DETAILS

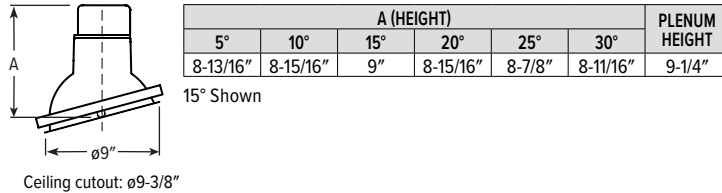

APERTURE ADAPTOR ORDERING INFO

ORDERING EXAMPLE: 4DR - GR - 0575 - WHT				
SERIES	CATALOG NUMBER	CEILING CUTOUT	FINISH	
4AR 6AR	GR	Specify ceiling cutout in 1/8" increments. Example: 5.75" = 0575	CS	Clear semi-specular powder coat
4DR 6DR			WH	White texture powder coat
4DS 6DS			BL	Black texture powder coat
4PR 6PR				
4PS 6PS				
8DR		See Kit Components for application limits.		

For use with remodel downlights. Additional finishes available, consult factory.
For limitations and instructions, see hew.com/aperture-adaptor.pdf

TRIM TYPE DETAILS

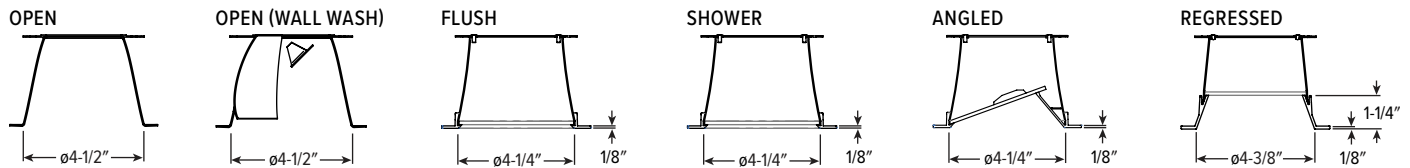

FLANGE TYPE DETAILS

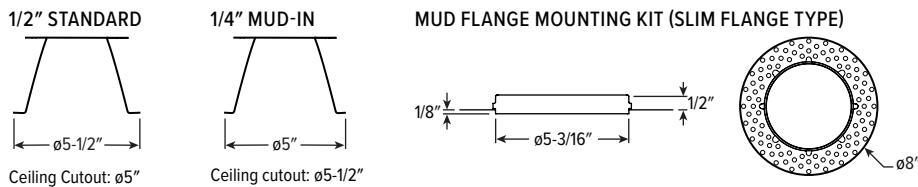

REFLECTOR FINISH DETAILS

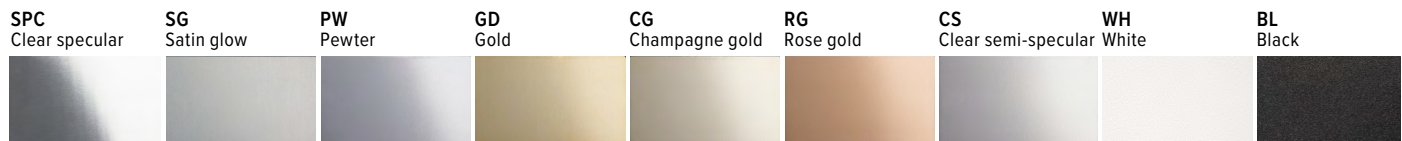

4DR dim to **WARM** 4.5" Downlight – Round

MOUNTING TYPE DETAILS

NEW CONSTRUCTION

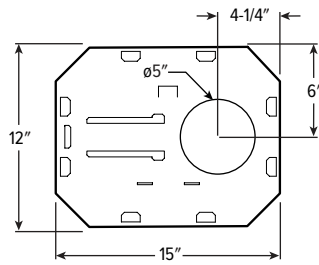

IC-RATED

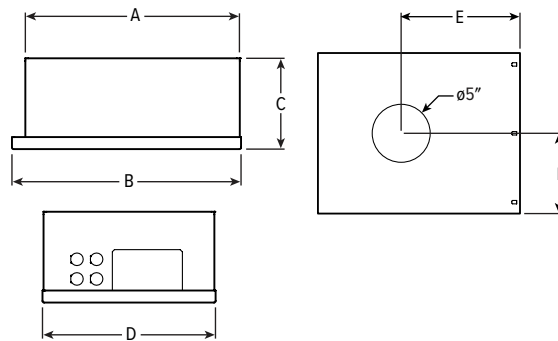

LUMENS	LENGTH					
	A	B	C	D	E	F
L8	15-3/16"	16"	6-3/8"	12-1/8"	9-1/2"	6-1/16"
L15	16-5/8"	17-1/2"	7-7/8"	14"	10-1/4"	7"

REMODEL

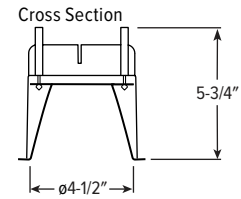

Receiver Bracket

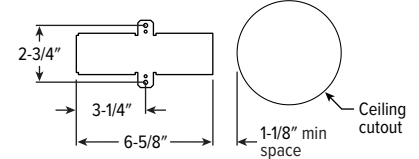

Driver and Junction Box

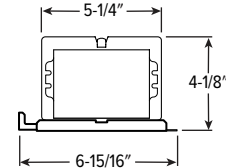

MOUNTING HARDWARE DETAILS

F1 Integral 2-position fixed pan bracket, universal bar hanger included

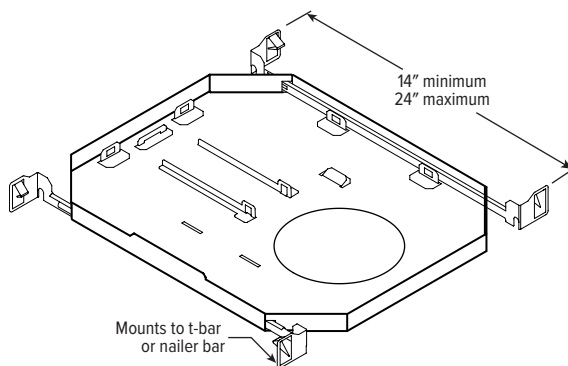

BA1 Adjustable butterfly pan bracket, bar hanger not included (N Mounting Type only)

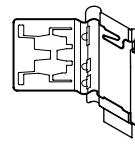

CA1 Adjustable caterpillar pan bracket, universal bar hanger included (N Mounting Type only)

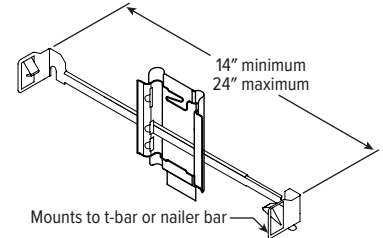

BA2 Adjustable butterfly pan bracket, heavy-duty universal bar hanger included (N Mounting Type only)

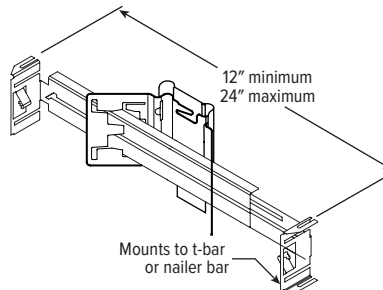

CA2 Adjustable caterpillar pan bracket, t-bar hanger included (N Mounting Type only)

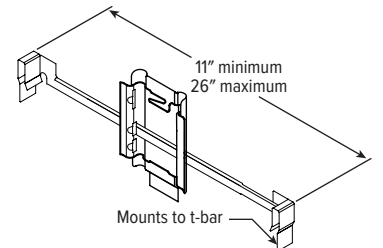

F1 with I Mounting Type

