

4AR dim to **WARM** 4.5" Adjustable Downlight – Round

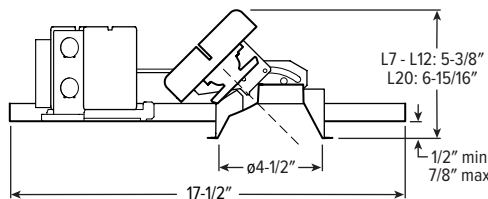

CATALOG #: _____

TYPE: _____

PROJECT: _____

NEW CONSTRUCTION AND REMODEL

ORDERING EXAMPLE: 4AR - L20/9DW - OPTIONS - DIM1 - UNV - OW - OF - CS - TRIM OPTIONS - N - F1



HOUSING

SERIES	LUMENS ^[1]	COLOR	OPTIONS	CONTROL	VOLTAGE
4AR	L7 700lm L12 1,200lm L20 2,000lm	9DW Dim to warm (95 CRI, 1800K – 3000K)	See page 4 for EMERGENCY BATTERY OPTIONS . ATH Airtight construction ^[2] CP Chicago plenum (CCEA) ^[3] F Fuse kit SDT Stepdown transformer ^[4]	DIM1 1% dimming driver (0-10V signal to control dimming and CCT) LUT Lutron Ecosystem enabled ^[5]	UNV 120-277V 347 347V ^[6]

TRIM ^[7]

TRIM TYPE	DISTRIBUTION ^[8]	FLANGE TYPE	REFLECTOR FINISH	TRIM OPTIONS
O Open reflector L Flush lens A Angled lens	W Wide 45° Open 40° Flush 30° Angled M Medium 30° Open 30° Flush 25° Angled N Narrow ^[9] 25° Flush 25° Angled	OF 1/2" standard flange SF 1/4" mud-in flange ^[10]	Open trim types CS Clear semi-specular anodize WH White texture powder coat BL Black texture powder coat Lens trim types CS Clear semi-specular powder coat WH White texture powder coat BL Black texture powder coat	MWT Textured white trim flange ^[11] AD Diffuse acrylic lens ^[12] PD Diffuse 1/8" polycarbonate lens ^[13] WET/CC Wet location, covered ceiling listed ^[14] AM Anti-microbial ^[15]

MOUNTING

MOUNTING TYPE ^[16]	MOUNTING HARDWARE ^[17]
N Open pan for new construction I IC-rated enclosure for new construction ^[18] R Remodel kit ^[19]	F1 Factory-installed 2-position fixed pan bracket, universal bar hanger included ^[20] BA1 Adjustable butterfly pan bracket, bar hanger not included ^[21] CA1 Adjustable caterpillar pan bracket, universal bar hanger included ^[22]

NOTES

¹ Lumen output based on full light output, O trim type, N distribution and CS finish, 3000K/95CRI. Actual lumens may vary +/-5%, see page 2 for FIXTURE PERFORMANCE DATA.

² I Mounting Type required.

³ I Mounting Type required.

⁴ May be required for 347V, see product builder a hew.com/product-builder.

⁵ Not available with I Mounting Type.

⁶ Not available with EM batteries.

⁷ Trim ships separately.

⁸ Beam angle based on CS or WH reflector finish.

⁹ L and A Trim Types only.

¹⁰ For use with mud-in plaster construction only, supplied with mud flange installation kit. See page 3 for FLANGE TYPE DETAILS. Not available with ATH option.

¹¹ Not available with WH Reflector Finish or L Trim Type.

¹² L and A Trim Types only. Wide distribution only.

¹³ L and A Trim Types only. Wide distribution only.

¹⁴ L and A Trim Types only. Not available with PD trim option.

¹⁵ WH and BL Reflector Finishes only.

¹⁶ Mounting hardware required (N and I only), ordered separately, see MOUNTING HARDWARE ordering info. See page 5 for MOUNTING HARDWARE DETAILS.

¹⁷ Additional mounting hardware options available. See page 4 for MOUNTING TYPE DETAILS.

¹⁸ L7 and L12 lumen packages only. Not available with EM batteries.

¹⁹ Also used in new construction sheetrock ceilings. Pan-less installation.

²⁰ N and I Mounting Types only. Universal bar hanger ships uninstalled. I Mounting requires external brackets.

²¹ N Mounting Type only.

²² N Mounting Type only.



4AR dim to **WARM** 4.5" Adjustable Downlight – Round

FEATURES

- Mimic the comfortable, welcoming glow of incandescent with warm-dimming technology
- Adjustable aim with 0° - 45° tilt and 360° rotation
- Beam angles ranging from 25° narrow to 45° wide for tailored performance
- 4 inch aperture is unobtrusive in small scale spaces
- New construction mounting pan, IC-rated, or pan-less remodel kit available
- Contemporary design provides glare-free illumination for a soft ceiling appearance
- Choice of open reflector or die-cast lensed trims to complement interior style
- Etched degree markers and directional indicator make it simple to fine-tune the illumination angle
- Spring clip retention system eliminates trim sag
- Fully room-side accessible

SPECIFICATIONS

- HOUSING** – Die-cast aluminum spun and stamped articulating mechanism with forged aluminum heat sink. Galvanized steel splice compartment with driver mounting plate/enclosure. Mounting clips allow for ceiling thickness from 1/2" - 7/8".
- OPEN REFLECTOR** – Low-iridescent anodized aluminum. Clear semi-specular finish standard.
- LENSED TRIM** – Die-cast aluminum frame with micro-prismatic, acrylic lens.
- ELECTRICAL** – High-performance Class 2 C.O.B. LED array. Modular quick-connect plug for easy field-connection of LED light assembly to driver. Reported L70>55,000 hours. Reported L90>55,000 hours. Estimated L70 = 200,000 hours.
- MOUNTING** – Recessed. 20 ga. galvanized steel mounting pan for new construction or IC-rated enclosure. Remodel kit option includes receiver bracket hardware. N and R mounting types for use in non-fire rated installations only.

- LISTINGS** –
 - cCSAus conforms to UL STD 1598; Certified to CAN/CSA STD C22.2 No. 250.0 for dry and damp locations. LED light assembly conforms to UL 2108 for remote installation.
 - Suitable for wet location under covered ceiling when specified with WET/CC option.
 - IC-rated for direct contact with insulation when specified with I Mounting Type.
 - City of Chicago Environmental Air approved when specified with CP option.
 - Complies with ASTM-E283 when specified with ATH option.
 - RoHS compliant.
 - Complies with the Buy American Act and other federal regulations. Request certification at hew.com/baa.
- WARRANTY** – 5-year limited warranty, see hew.com/warranty.

FIXTURE PERFORMANCE DATA

OPEN REFLECTOR TRIM TYPE

	DISTRIBUTION	DELIVERED LUMENS	CCT AT 100% (FULL OUTPUT)	CCT AT 1% (FULL DIM)	WATTAGE	EFFICACY (lm/W)
L7	W	466	3000K	1800K	14.0	33
	M	648			14.0	46
	N	–			–	–
L12	W	818			23.4	35
	M	1136			23.4	49
	N	–			–	–
L20	W	1339			37.7	36
	M	1860			37.7	49
	N	–			–	–

FLUSH LENS TRIM TYPE

	DISTRIBUTION	DELIVERED LUMENS	CCT AT 100% (FULL OUTPUT)	CCT AT 1% (FULL DIM)	WATTAGE	EFFICACY (lm/W)
L7	W	462	3000K	1800K	14.0	33
	M	625			14.0	45
	N	656			14.0	47
L12	W	811			23.4	35
	M	1096			23.4	47
	N	1149			23.4	49
L20	W	1327			37.7	35
	M	1796			37.7	48
	N	1882			37.7	50

ANGLED LENS TRIM TYPE

	DISTRIBUTION	DELIVERED LUMENS	CCT AT 100% (FULL OUTPUT)	CCT AT 1% (FULL DIM)	WATTAGE	EFFICACY (lm/W)
L7	W	330	3000K	1800K	14.0	24
	M	483			14.0	35
	N	586			14.0	42
L12	W	578			23.4	25
	M	846			23.4	36
	N	1027			23.4	44
L20	W	947			37.7	25
	M	1386			37.7	37
	N	1682			37.7	45

MULTIPLIER TABLES

OPEN REFLECTOR FINISH		TRIM	
CATALOG NUMBER	CONVERSION FACTOR	CATALOG NUMBER	CONVERSION FACTOR
CS	1.00	AD ¹	0.85
WH	0.89	PD ¹	0.85
BL	0.79		

- Distribution will also be affected, consult factory.
- Photometrics tested in accordance with IESNA LM-79. Results shown are based on 25°C ambient temperature.
- Wattage shown is based on 120V input.
- Results based on 3000K, 95 CRI, full output, 0° tilt, actual lumens may vary +/-5%.
- To calculate lumen output in emergency mode, multiply the battery wattage by the efficacy.
- Use multiplier tables to calculate additional options.

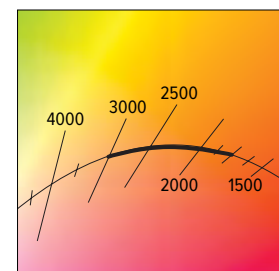

PHOTOMETRY

4AR-L20/9DW-DIM1-UNV-OW-OF-CS (25° tilt) Total Luminaire Output: 1355 lumens; 37.7 Watts | Efficacy: 35.9 lm/W | 95.0 CRI; 3000K CCT

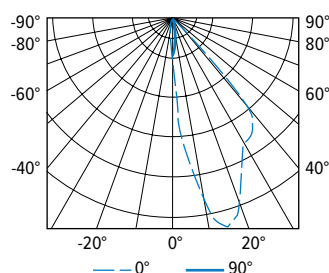

CANDLEPOWER DISTRIBUTION	VERTICAL ANGLE	HORIZONTAL ANGLE					ZONAL LUMENS
		0°	45°	90°	135°	180°	
	0	788	788	788	788	788	
	5	2389	1675	653	270	195	97
	15	4321	2360	253	61	40	319
	25	3255	2150	64	17	15	425
	35	2817	991	12	8	11	399
	45	582	30	5	4	3	112
	55	6	0	0	0	3	2
	65	1	0	0	0	0	0
	75	0	0	0	0	0	0
	85	0	0	0	0	0	0
	90	0	0	0	0	0	0

LUMEN SUMMARY	ZONE	LUMENS	% FIXTURE
	0 - 40	1240	92
	0 - 60	1354	100
	0 - 90	1355	100
	0 - 180	1355	100



H.E. Williams, Inc.

Carthage, Missouri

www.hew.com

417-358-4065

Designed and Manufactured in the USA

Information contained herein is subject to change without notice.

REV.08/30/23.LA

Downlights
Page 2 of 5

4AR

dim to **WARM**
 4.5" Adjustable Downlight – Round

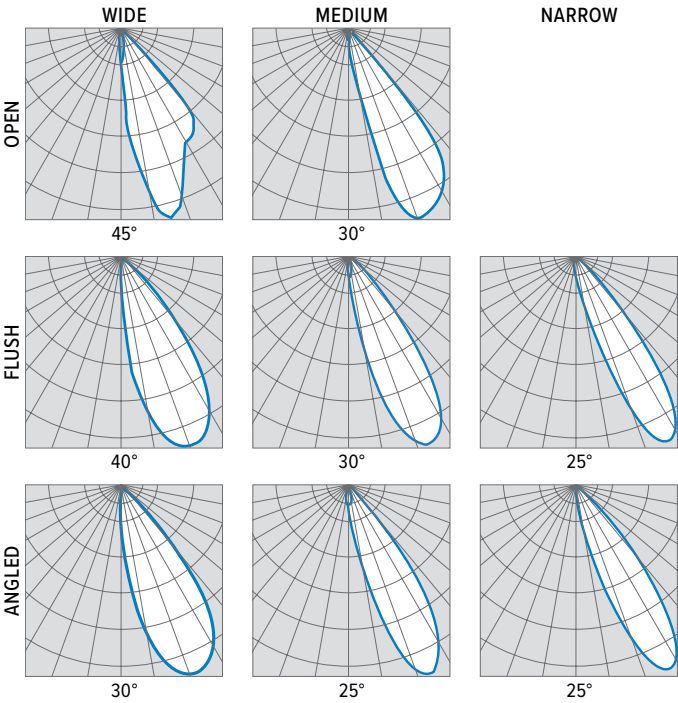

TRIM TYPE DETAILS

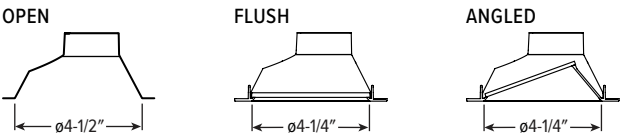

FLANGE TYPE DETAILS

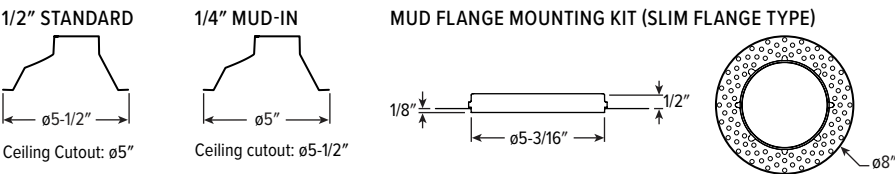

REFLECTOR FINISH DETAILS

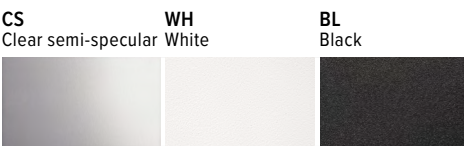

4AR dim to **WARM**

4.5" Adjustable Downlight – Round

EMERGENCY BATTERY OPTIONS

Additional limitations apply, see page 1. Specify CEC in the option code when California Energy Commission regulations are required.

CATALOG NUMBER	DESCRIPTION
EM/7W	7-watt emergency battery
EM/7W/RTS	7-watt emergency battery with regressed test switch ¹
EM/7W/IPRTS	7-watt emergency battery with IP65 rated regressed test switch
EM/10W	10-watt emergency battery
EM/10W/RTS	10-watt emergency battery with regressed test switch ¹
EM/10W/IPRTS	10-watt emergency battery with IP65 rated regressed test switch

¹ Not available with WET/CC Option.

REGRESSED TEST SWITCH DETAILS

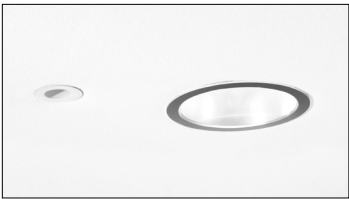

Shown Installed

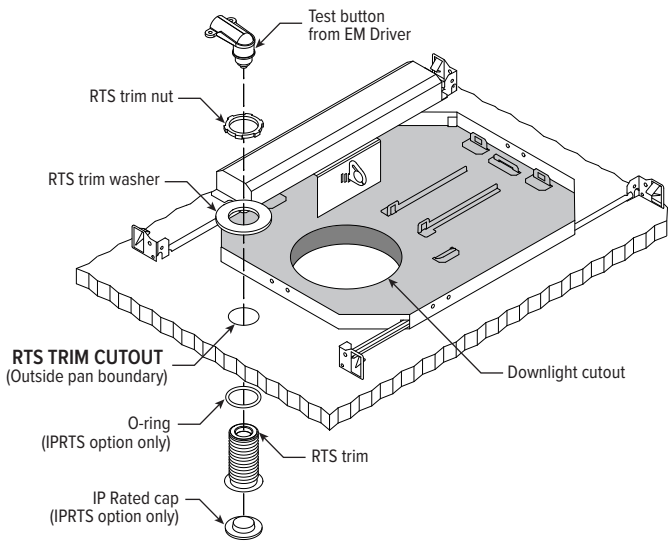

MOUNTING TYPE DETAILS

NEW CONSTRUCTION

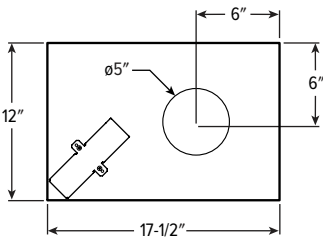

IC-RATED

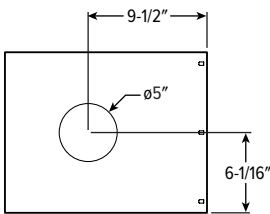
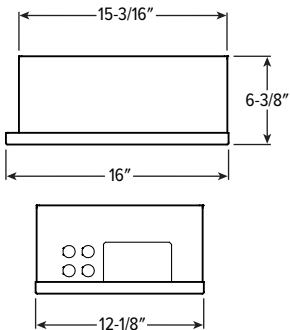

REMODEL

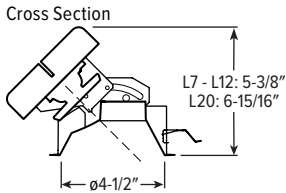

Receiver Bracket

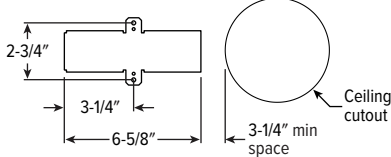

Driver and Junction Box

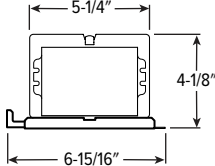

4AR

dim to

WARM

4.5" Adjustable Downlight – Round

APERTURE ADAPTOR ORDERING INFO

ORDERING EXAMPLE: 4DR - GR - 0575 - WHT				
SERIES	CATALOG NUMBER	CEILING CUTOUT	FINISH	
4AR	6AR	GR	CS	Clear semi-specular powder coat
4DR	6DR		WH	White texture powder coat
4DS	6DS		BL	Black texture powder coat
4PR	6PR			
4PS	6PS			
	8DR			
		Specify ceiling cutout in 1/8" increments. Example: 5.75" = 0575		
		See Kit Components for application limits.		

For use with remodel downlights. Additional finishes available, consult factory.
For limitations and instructions, see hew.com/aperture-adaptor.pdf

MOUNTING HARDWARE DETAILS

F1 Factory-installed 2-position fixed pan bracket, universal bar hanger included, ships uninstalled

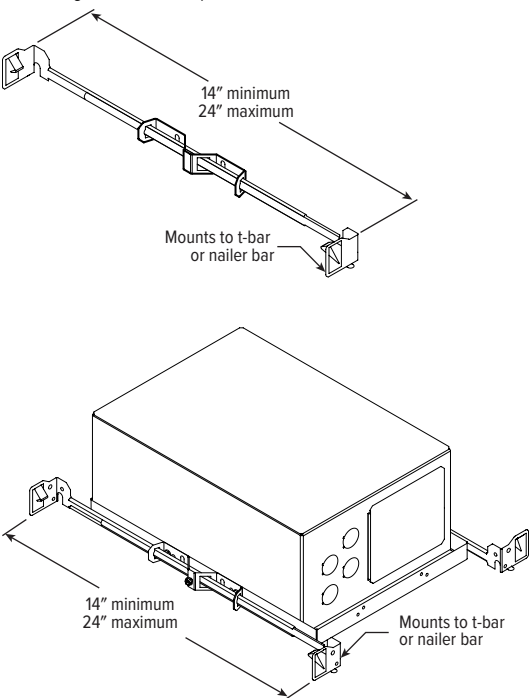

F1 with I Mounting Type

BA1 Adjustable butterfly pan bracket, bar hanger not included (N Mounting Type only)

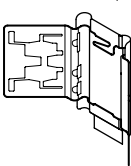

CA1 Adjustable caterpillar pan bracket, universal bar hanger included (N Mounting Type only)

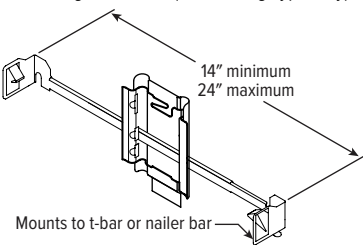

BA2 Adjustable butterfly pan bracket, heavy-duty universal bar hanger included (N Mounting Type only)

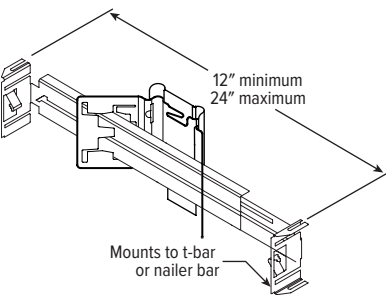

CA2 Adjustable caterpillar pan bracket, t-bar hanger included (N Mounting Type only)

